



Paediatric range pg 55



Technical Guide

Moving & Handling Range

CONTENTS

P4-33	Hoisting
P4-10	Ceiling track hoists
P11	Turntables
P12	Carry bar options
P12	Weigh module
P13-16	Modular gantry systems
P16	T frame gantry
P17-21	Track & track accessories
P20-21	X-Y to Mono systems
P22	Mobile hoist
P23-33	Sling range
P34-54	Bathing
P34-46	Shower chairs P35-37 Transaqua P38-44 Aquamaster P45-46 Tilt in space chair
P47-48	Shower cradles P47 Tilt in space cradle P48 Washington cradle
P49	Shower trolleys
P50-52	Shower/changing stretchers
P53-54	Height adjustable shower/changing benches
P55-62	Paediatirc Range
P56	Slings
P57-58	Shower chair
P59-60	Tilt in space chair
P61	Tilt in space cradle
P62	Shower trolley

SYMBOLS: Bulk item

Made to order

Anti-microbial coating

(see P68 for details)



Tel: 01869 365500 Email: sales@chilterninvadex.co.uk

www.chilterninvadex.co.uk



Installation only - for safety reasons hoisting equipment can only be supplied to authorised dealers or on an installation basis. Please contact Customer Services for further information on 01869 365500 opt 1.

**CEILING TRACK HOISTS
MOBILE HOISTS
SLINGS**

OVERHEAD HOISTS

Explanation of Wispa overhead hoist options



Wispa 100 Plus hoist range

Maximum Load 130kg (20 stones) (286lb) Standard models

Maximum Load 200kg (31 stones) (440lb) Turbo models

- Up/down/traverse/X-Y options
- Battery or transformer models (transformer models have no battery to recharge) and are ideal for tracks up to 3 metres
- Infra-red hand control options
- Battery models 60 lifts per charge (based on average 70kg patient weight)



Wispa Max hoist range

Max Load 272kg (42 stones) (598lb)

- Up/down/traverse/X-Y options
- Battery operated
- Infra-red hand control options
- Up to 200 lifts per charge (based on average 70kg patient weight)

A detailed Specifiers Guide is available to Architects and scheme specifiers.
Please call customer services on 01869 365500 opt 1 to obtain a copy



OVERHEAD HOISTS



Wispa 100 Plus hoist range

Maximum Load 130kg (20 stones) (286lb) Standard models

Maximum Load 200kg (31 stones) (440lb) Turbo models

- Power options to suit
- Economical but simple to recharge
- Safe, controlled handling
- Emergency stop with reset facility
- Emergency lowering
- Lift motor has a self lock facility
- Tested to the durability section of British Standard 10535 with 11 thousand lift and lower tests
- Installation quotation subject to site survey

130kg models	Function	200kg models	Function
Transformer		Transformer	
OHWPLEU	Manual traverse	OHWTPLEU	Manual traverse
OHWLPLEU	Powered traverse	OHWLTPLEU	Powered traverse
Battery		Battery	
OHWBPLEU	Manual traverse	OHWTBPLEU	Manual traverse
OHWLBPLEU	Powered traverse	OHWLTBPLEU	Powered traverse
OHWLBPLEUXY	Powered traverse XY	OHWLTBPLEUXY	Powered traverse XY
OHWLBPLEUXY-M*	Powered traverse, aux bullets	OHWLTBPLEUXY-M	Powered traverse, aux bullets
N. America model 130kg - Transformer		N. America model 200kg - Transformer	
Manual traverse option not available see 190kg model		OHWTPLUS	Manual traverse
OHWLPLUS	Powered traverse	OHWLTPLUS	Powered traverse

Hoist Selection Guide

Select the required function from the charts below

Model	Powered lift	Powered traverse	Auxillary output 'X-Y' (cable)	Auxillary output 'X-Y' (bullet)	130kg max load	200kg max load
OHWBPLEU	●				●	
OHWLBPLEU	●	●			●	
OHWLBPLEUXY	●	●	●		●	
OHWLBPLEUXY-M*	●	●		●	●	
OHWTBPLEU	●					●
OHWLTBPLEU	●	●				●
OHWLTBPLEUXY	●	●	●			●
OHWLTBPLEUXY-M*	●	●		●		●

Configuration Options

Model	Infra-red control	Manual turntable	Powered turntable	Manual X-Y	Powered X-Y	Manual X-Y to mono	Powered X-Y to mono
OHWBPLEU		●		●		●	
OHWLBPLEU	●**	●		●		●	
OHWLBPLEUXY	●**				●		
OHWLBPLEUXY-M*	●**	●	●		●	●	●
OHWTBPLEU		●		●		●	
OHWLTBPLEU	●**	●		●		●	
OHWLTBPLEUXY	●**		●		●		
OHWLTBPLEUXY-M*	●**	●			●	●	●

* auxillary output bullets must be specified for intended use. **IR control must be specified at time of order.
Installation quotation subject to site survey.



OVERHEAD HOISTS



Wispa Max hoist range

Maximum Load 272kg (42 stones) (599lb) Standard models

- Power options to suit
- Economical but simple to recharge
- Safe, controlled handling
- Emergency stop with reset facility
- Emergency lowering
- Tested to the durability section of British Standard 10535 with 11 thousand lift and lower tests
- Installation quotation subject to site survey

Model	Function
OHWMBPLEU	Manual traverse
OHWLMBPLEU	Powered traverse
OHWLMBPLEU-IR	Powered traverse, Infra red control
OHWLMBPLEUXY	Powered traverse XY
OHWLMBPLEUXY-IR	Powered traverse XY, Infra red control
OHWLMBPLEUXY-M	Powered traverse, aux bullets
N. America model	
OHWMBPLUS	Manual traverse
OHWLMBPLUS	Powered traverse
OHWLMBPLUS-IR	Powered traverse, Infra red control
OHWLMBPLUSXY	Powered traverse XY

Hoist Selection Guide

Select the required function from the charts below.

Model	Powered lift	Powered traverse	Auxillary output 'X-Y' (cable)	Auxillary output 'X-Y' (bullet)
OHWMBPLEU	●			
OHWLMBPLEU or OHWLMBPLUS	●	●		
OHWLMBPLEUXY or OHWLMBPLUSXY	●	●	●	
OHWLMBPLEUXY-M*	●	●		●

Configuration Options

Model	Infra-red control	Manual turntable	Powered turntable	Manual X-Y	Powered X-Y	Manual X-Y to mono	Powered X-Y to mono
OHWMBPLEU		●		●		●	
OHWLMBPLEU		●		●		●	
OHWLMBPLEU-IR	●	●		●		●	
OHWLMBPLEUXY					●		
OHWLMBPLEUXY-IR	●				●		
OHWLMBPLEUXY-M*		●	●		●	●	●

* auxillary output bullets must be specified for intended use.
Installation quotation subject to site survey.

SYMBOLS: Bulk item
Made to order
Anti-microbial coating
(see P68 for details)



Tel: 01869 365500 Email: sales@chilterninvadex.co.uk
www.chilterninvadex.co.uk

OVERHEAD HOISTS

Wispa 100 and Max hoist ranges Technical information

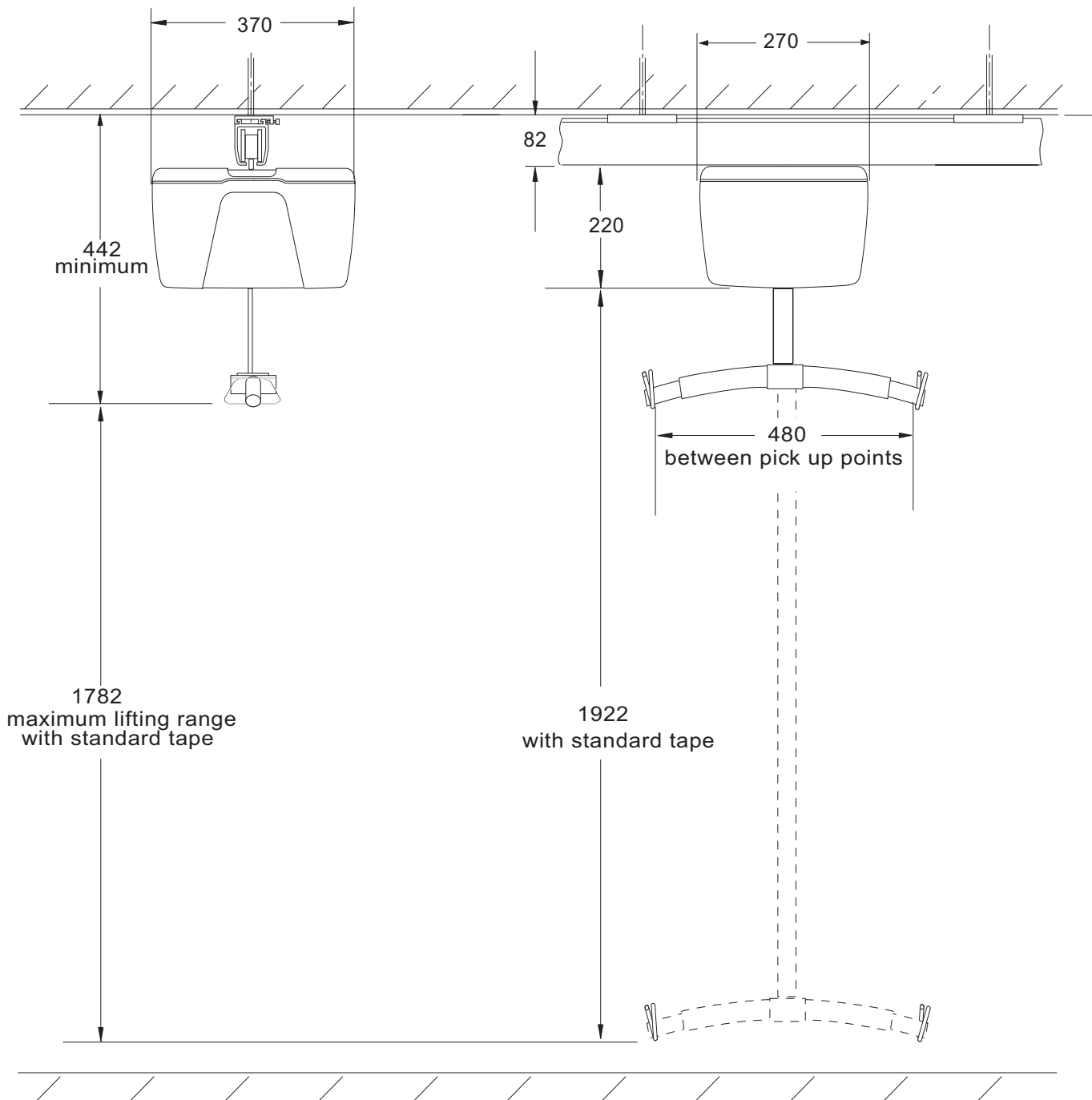

Notes:

- Extended lifting tapes are available as an optional extra
- A three prong spreader bar is available to offer additional pick up points where required (see page 12)
- Hanger bars to suit the three prong spreader bar are available which provide a wider pick up distance for the comfort of larger users (see page 12)
- CAD Drawings of hoists available by contacting technical@chilterninvadex.co.uk

SYMBOLS: Bulk item
Made to order
Anti-microbial coating
(see P68 for details)



Tel: 01869 365500 Email: sales@chilterninvadex.co.uk
www.chilterninvadex.co.uk

OVERHEAD HOISTS

Wispa 100 hoist with X-Y Installation

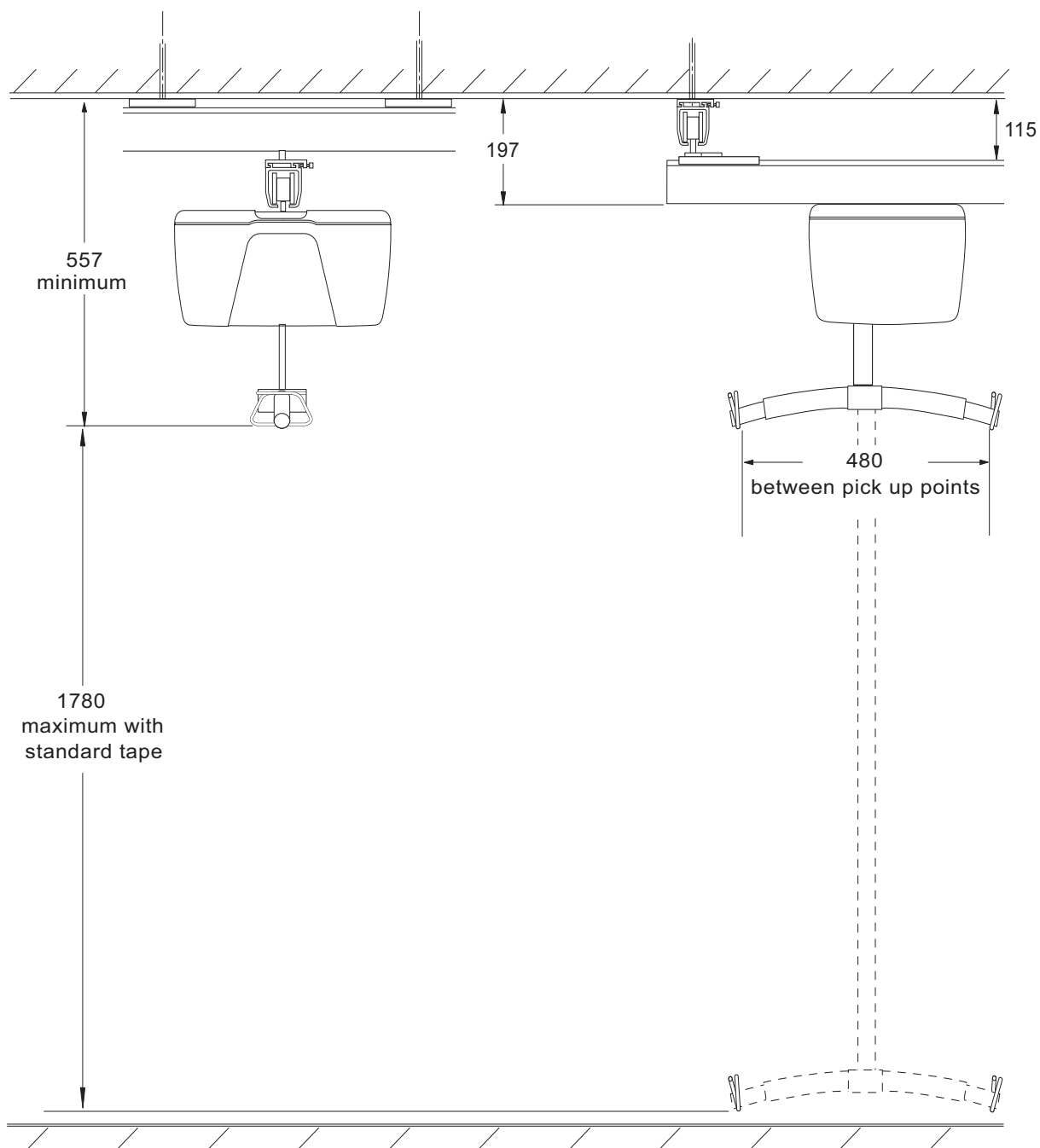

OVERHEAD HOISTS

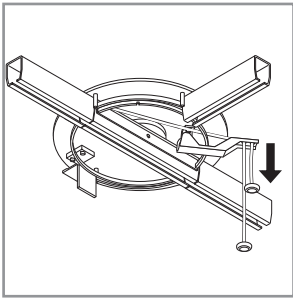

Manual turntable

- The manual turntable is designed to allow a Wispa ceiling track hoist to be rotated, enabling the hoist to transfer from one track to another.

code	product	description
OHTRK12A	Manual turntable	with 1m track (c/w tails x 3)
OHA0048AR	Additional tail (1m)	right hand

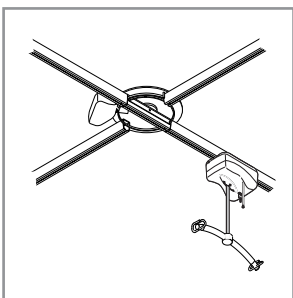

Powered turntable

Maximum Load 272kg (42 stones) (598lb)

- The powered turntable is designed to allow a Wispa ceiling track hoist to be rotated, enabling the hoist to transfer from one track to another.
- Easy operation via handset control
- Modified hoist required (cannot be used with WispaLite)

code	product	description
OHTRK12ELA	Powered turntable	with 1m track (c/w tails x 3)
OHA0048AR	Additional tail (1m)	right hand

Note: Track can be cut to size on site.

A detailed Specifiers Guide is available to Architects and scheme specifiers. Please call customer services on 01869 365500 to obtain a copy



OVERHEAD HOISTS

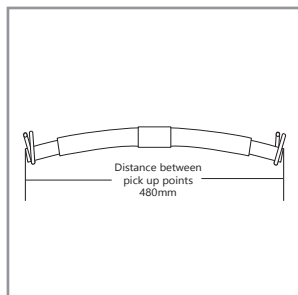

Wispa hoist standard carry bar
Maximum Load 272kg (42 stones) (598lb)

- Only approved for use on Chiltern Invadex ceiling track hoists

code	product
OHCB2-000	Standard carry bar

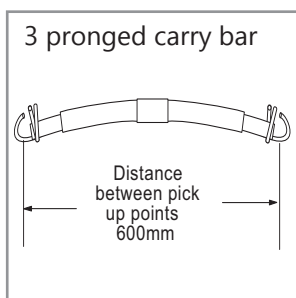

Wispa hoist 3 pronged carry bar
Maximum Load 272kg (42 stones) (598lb)

- The 3 pronged carry bar when used with the spreader bar offers a wider pick-up distance for added client comfort. The 3 pronged carry bar also offers a third attachment point, if required.
- Only approved for use on Chiltern Invadex ceiling track hoists

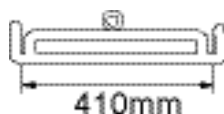
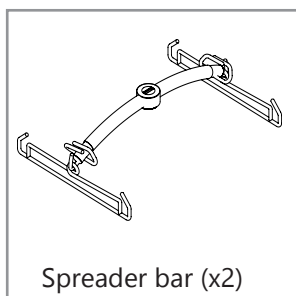

code	product
OHCB3-000	3 pronged carry bar
OHHS136	spreader bar (sold in pairs)

Hoist Weigh Module

Class III certified, the weigh module is approved for use in hospitals, nursing homes and other care environments where medication is determined by weight measurement.



- Suitable for use with ceiling hoists featuring a three prong hook configuration.
- Easy to read digital screen
- 200kg weighing capacity in 100g graduations
- BMI calculation function
- Rechargeable battery with upto 40 hours continuous use
- Low battery warning

code	product
WM0010	Weigh module
WM0011	Storage/carry case

A detailed Specifiers Guide is available to Architects and scheme specifiers. Please call customer services on 01869 365500 to obtain a copy



GANTRY SYSTEMS

Normally a ceiling track hoist would be fitted to the ceiling, but the construction of some rooms can make the fixing of a system difficult and a modular, portable or heavy duty gantry system may be more appropriate.

Modular gantry systems



To overcome a plasterboard false ceiling a Modular Gantry system is a practical answer. Featuring wall and floor brackets, allowing the gantry legs to be positioned mid-wall, and additional legs to straddle windows and doorways, the Gantry system offers maximum flexibility, resolving many construction anomalies. It can support users up to 200kgs (30 stones) (440lb) over a 3 metre span of track, providing the floor construction is adequate (above this weight a heavy duty gantry system is required). The standard leg length is 3 metres and can be cut on site to suit requirements. Please contact Chiltern Invadex to arrange a site visit.

It can also be positioned to allow the hoist to traverse at an angle across the room, for example from a bed to a toilet, or to accommodate the room layout. The offset leg option enables obstructions such as pipework or skirting boards to be cleared.

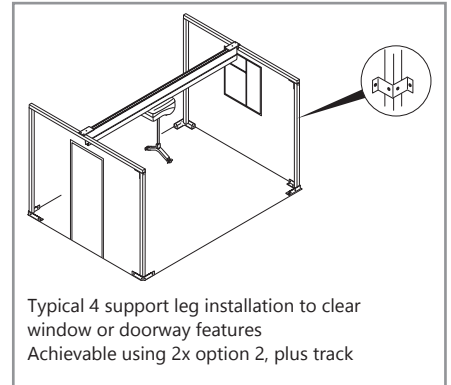
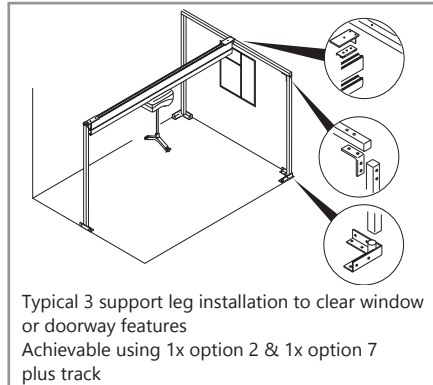
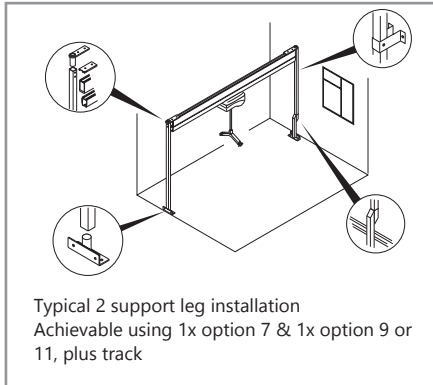

Goal post kits to span windows and doors Maximum Load 200kg (31 stones) (440lb)

Kit contents: as detailed below. Goal post kits do not include track. For single legs see page 15

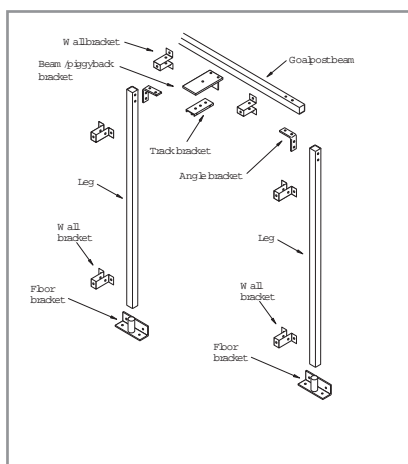

Option 1

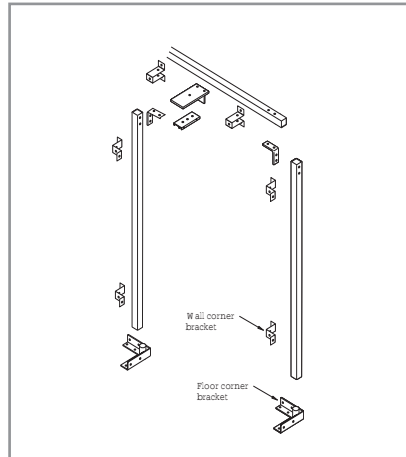

Option 2

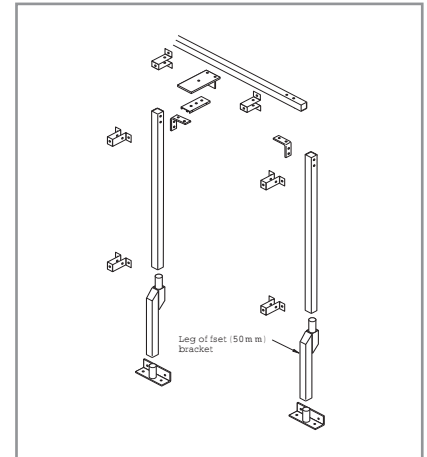

Option 3

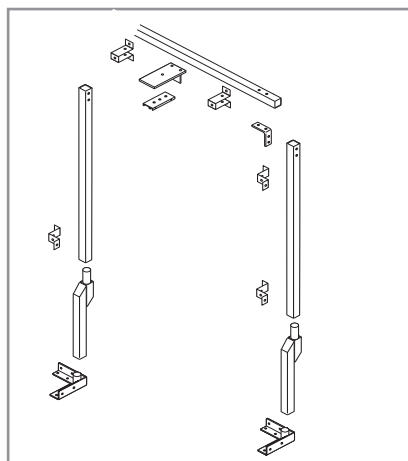

Option 4

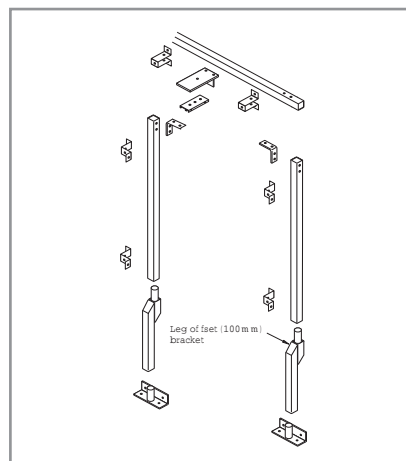

Option 5

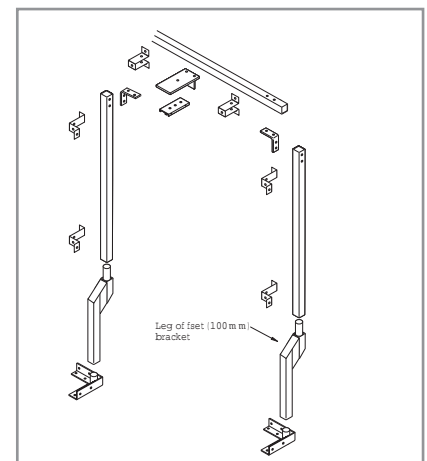

Option 6

SYMBOLS: Bulk item
Made to order
Anti-microbial coating
(see P68 for details)



Tel: 01869 365500 Email: sales@chilterninvadex.co.uk
www.chilterninvadex.co.uk

GANTRY SYSTEMS - GOAL POST KITS

Modular gantry system - option 1

Chiltern Invadex modular gantry systems are available with 65mm or 115mm wall bracket options

code	product
303-00201	Legs/Top & Beam/Floor Bracket/65mm Wall Bracket
303-00203	Legs/Beam/Floor Bracket/115mm Wall Bracket

Modular gantry system - option 2

Chiltern Invadex modular gantry systems are available with 65mm or 115mm wall bracket options

code	product
303-00202	Legs/Beam/Corner Floor Bracket/65mm Corner Wall Bracket
303-00204	Legs/Beam/Corner Floor Bracket/115mm Corner Wall Bracket

Modular gantry system - option 3

Chiltern Invadex modular gantry systems are available with 65mm or 115mm wall bracket options

code	product
303-00205	Legs/Beam/Floor Bracket/65mm Wall Bracket/50mm leg Offset
303-00207	Legs/Beam/Floor Bracket/115mm Wall Bracket/50mm leg Offset

Modular gantry system - option 4

Chiltern Invadex modular gantry systems are available with 65mm or 115mm wall bracket options

code	product
303-00206	Legs/Beam/Corner Floor Bracket/65mm Corner Wall Bracket/50mm leg Offset
303-00208	Legs/Beam/Corner Floor Bracket/115mm Corner Wall Bracket/50mm leg Offset

Modular gantry system - option 5

Chiltern Invadex modular gantry systems are available with 65mm or 115mm wall bracket options

code	product
303-00209	Leg/Beam/Floor Bracket/65mm Wall Bracket/100mm leg Offset
303-00211	Leg/Beam/Floor Bracket/115mm Wall Bracket/100mm leg Offset

Modular gantry system - option 6

Chiltern Invadex modular gantry systems are available with 65mm or 115mm wall bracket options

code	product
303-00210	Legs/Beam/Corner Floor Bracket/65mm Corner Wall Bracket/100mm leg Offset
303-00212	Legs/Beam/Corner Floor Bracket/115mm Corner Wall Bracket/100mm leg Offset

A detailed Specifiers Guide is available to Architects and scheme specifiers. Please call customer services on 01869 365500 to obtain a copy



GANTRY SYSTEMS - SINGLE LEG KITS

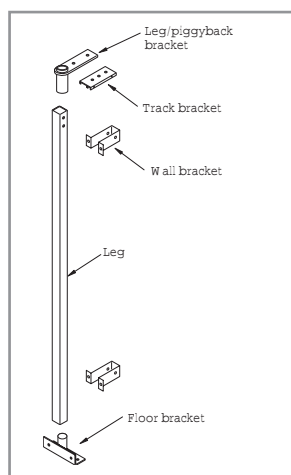

Option 7

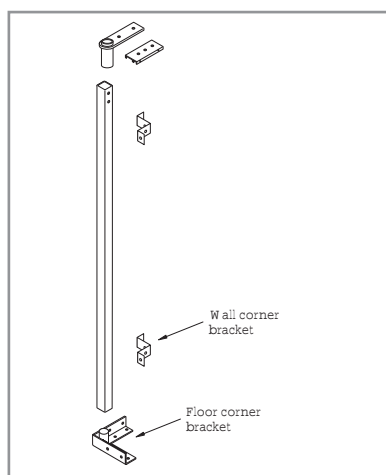

Option 8

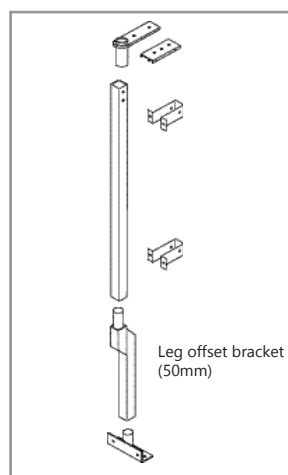

Option 9

Kit contains:

Floor bracket (x1), angle bracket (x1), beam/piggyback bracket (x1), gantry leg (x1), track bracket (x1), wall brackets (x2).

Note: Kits do not include wall fixings or track.

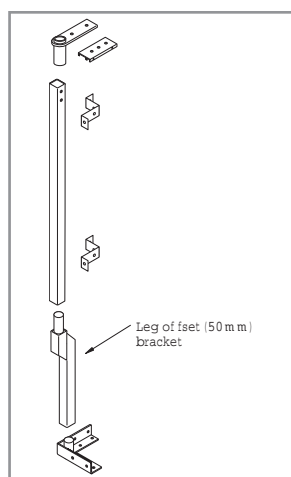

Option 10

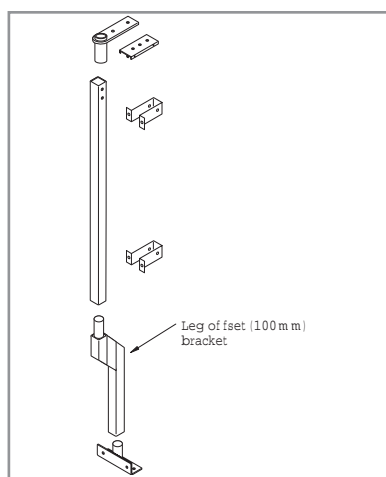

Option 11

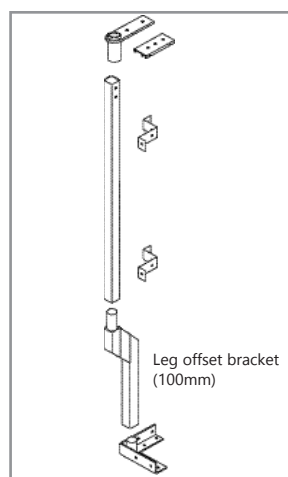

Option 12

Modular gantry system - option 7

Chiltern Invadex modular gantry systems are available with 65mm or 115mm wall bracket options

code	product
303-00101	Legs/Top & Floor Bracket/65mm Wall Bracket
303-00103	Legs/Top & FloorBracket/115mm Wall Bracket

Modular gantry system - option 8

Chiltern Invadex modular gantry systems are available with 65mm or 115mm wall bracket options

code	product
303-00102	Legs/Top & Corner Floor Bracket/65mm Corner Wall Bracket
303-00104	Legs/Top & Corner Floor Bracket/115mm Corner Wall Bracket

Modular gantry system - option 9

Chiltern Invadex modular gantry systems are available with 65mm or 115mm wall bracket options

code	product
303-00105	Legs/Top & Floor Bracket/65mm Wall Bracket/50mm Offset
303-00107	Legs/Top & Floor Bracket/115mm Wall Bracket/50mm Offset

SYMBOLS: Bulk item
Made to order
Anti-microbial coating
(see P68 for details)



Tel: 01869 365500 Email: sales@chilterninvadex.co.uk
www.chilterninvadex.co.uk

SINGLE LEG KITS

Modular gantry system - option 10

Chiltern Invadex modular gantry systems are available with 65mm or 115mm wall bracket options

code	product
303-00106	Legs/Top & Corner Floor Bracket/65mm Corner Wall Bracket/50mm Offset
303-00108	Legs/Top & Corner Floor Bracket/115mm Corner Wall Bracket/50mm Offset

Modular gantry system - option 11

Chiltern Invadex modular gantry systems are available with 65mm or 115mm wall bracket options

code	product
303-00109	Legs/Top & Floor Bracket/65mm Wall Bracket/100mm Offset
303-00111	Legs/Top & Floor Bracket/115mm Wall Bracket/100mm Offset

Modular gantry system - option 12

Chiltern Invadex modular gantry systems are available with 65mm or 115mm wall bracket options

code	product
303-00110	Legs/Top & Corner Floor Bracket/65mm Corner Wall Bracket/100mm Offset
303-00112	Legs/Top & Corner Floor Bracket/115mm Corner Wall Bracket/100mm Offset

T FRAME GANTRY



- Designed for use with the WispaLite portable hoist (see page 12)
- Perfect for bed to chair transfers
- Totally self supporting with no need for wall or floor fixing methods
- An affordable alternative to a permanent track installation
- No power supply required
- Ideal temporary solution
- Adjustable height from 2060mm to 2380mm
- Track length 2500mm
- A simple modular style construction allows a light weight and transportable system
- Maximum load 200kg (31 stone)

code	product
OHTRK15	T Frame Gantry (kit includes 2x adjustable legs and 2.5m track)

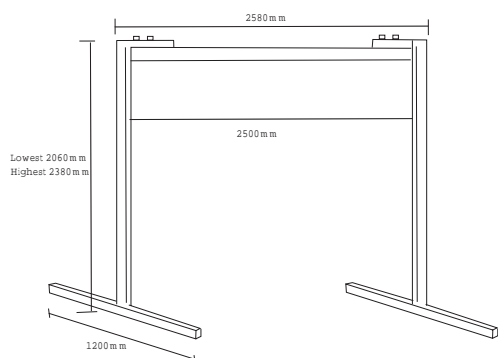

SYMBOLS: Bulk item
Made to order
Anti-microbial coating
(see P68 for details)



Tel: 01869 365500 Email: sales@chilterninvadex.co.uk
www.chilterninvadex.co.uk

TRACK & ACCESSORIES

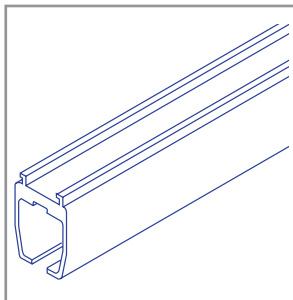

Straight track

- Standard straight track
- 2.5, 3, 4 and 5m length options
- Cut lengths upto 5m available on request

code	product	description
OHTNP-25	Straight track	2.5m length
OHTNP-3	Straight track	3m length
OHTNP-4	Straight track	4m length
OHTNP-5	Straight track	5m length

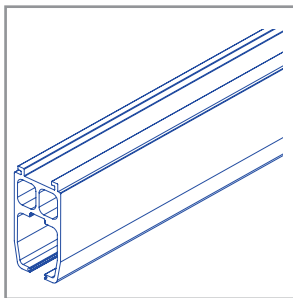

Combined track

Our standard track profile combined with an additional reinforced element to allow longer free spans between wall brackets, gantry legs or X-Y beams.

code	product	description
OHTNP-25C	Combined track	2.5m combined track
OHTNP-3C	Combined track	3m combined track
OHTNP-4C	Combined track	4m combined track
OHTNP-5C	Combined track	5m combined track

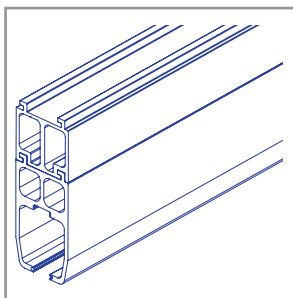

Piggyback Track

Box section for use with combined track to increase unsupported length

code	product	description
OHTNP-25C	Combined track	2.5m combined track

Busbar

- Busbar strip which can be installed into straight track to provide continuous charge to track hoists (excluding the wispalite)
- Prevents the need for hoist docking
- Requires straight or combined track (see above)

code	product	description
OHTNP-BUSB	Busbar	purchased in 1m lengths



TRACK & ACCESSORIES

Track Brackets

Track brackets

Single

Joiner

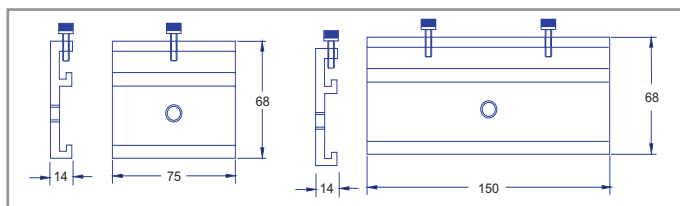

Wall Bracket

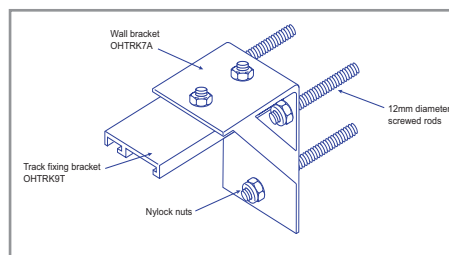

code	product
OHTRK8T	Track bracket (Single)
OHTRK9T	Track joiner and support (Double\Joiner)
OHTRK7A	Wall bracket (to be used in conjunction with OHTRK9T)

Offset brackets

code	product
OHTRK10TLH	Offset joiner bracket left hand
OHTRK10TRH	Offset joiner bracket right hand

Note: These brackets are designed to align track and not to provide support. Additional support is required.

Loft over kit

code	product
OHTRK23	Loft over kit - 1.5m

Between floor kit

code	product
OHTRK24	Between floor kit - 750mm

Trapeze bracket kit

code	product
OHTRK19	Track trapeze bracket kit

Track support tube

code	product
OHTRK22	40mm box white - 1.2m

Unistrut

code	product
OHTRK18	750mm surface Unistrut Kit

Stop ends

code	product
OHTRK11A	Stop end (Short)
OHTRK11B	Stop end (Long)

Track end cap

code	product
OHTRK25	Track end cap (to suit old style single track pre 2018)
OHTNP-CAP	Track end cap (to suit new profile)
OHTNP-COMCAP	Track end cap - Combined track
OHTRK0392	X-Y end cap

Trolley sets

code	product
OHTRK13	X-Y manual trolley set (pair)
OHTRK14	X-Y powered trolley set (pair)
OHTRK16	Double trolley wheel
OHTRK16A	Glide lock trolley

A detailed Specifiers Guide is available to Architects and scheme specifiers. Please call customer services on 01869 365500 to obtain a copy



TRACK BENDS

Curved track

A range of standard bends are available - 90, 45, 30, 15, 10 degree. Track is handed and supplied with inner or outer profiles as illustrated right. The sections used will depend on the intended track layout.

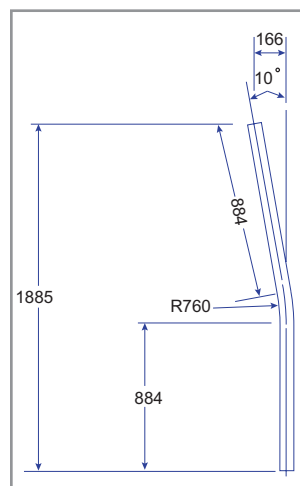

Curved track 10 degrees

code	product
OHTNP-10INT	10 degree bend (internal)
OHTNP-10EXT	10 degree bend (external)

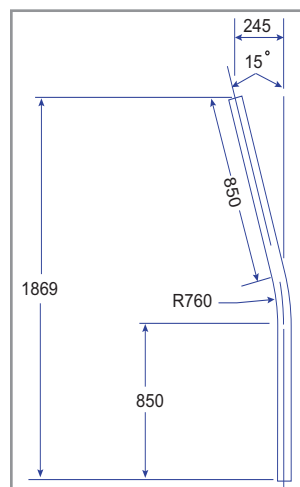
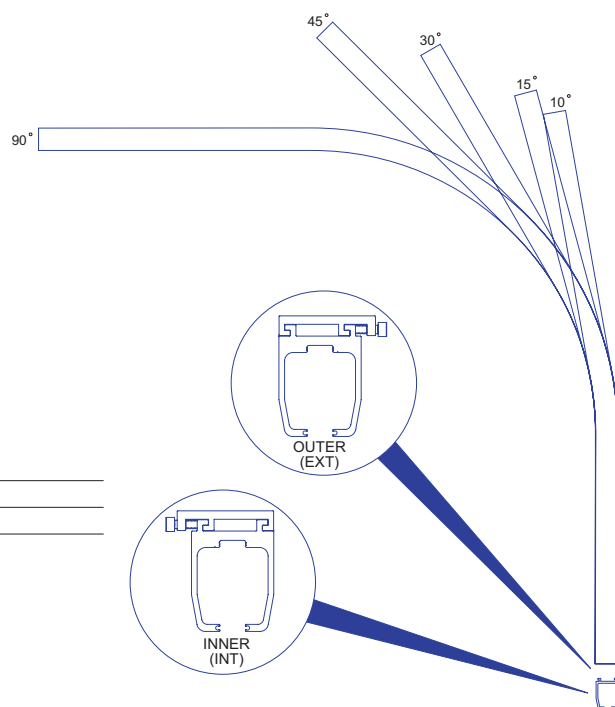

Curved track 15 degrees

code	product
OHTNP-15INT	15 degree bend (internal)
OHTNP-15EXT	15 degree bend (external)

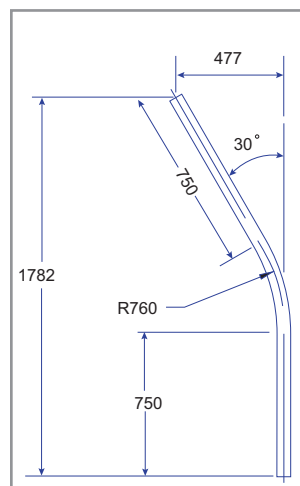

Curved track 30 degrees

code	product
OHTNP-30INT	30 degree bend (internal)
OHTNP-30EXT	30 degree bend (external)

SYMBOLS: Bulk item
Made to order
Anti-microbial coating
(see P68 for details)



Tel: 01869 365500 Email: sales@chilterninvadex.co.uk
www.chilterninvadex.co.uk

TRACK BENDS

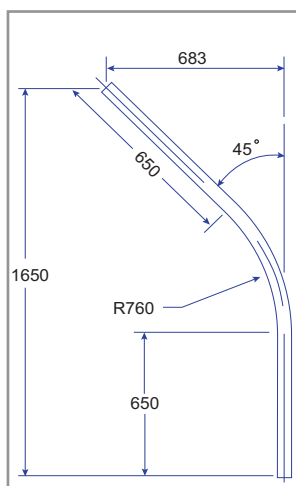

Curved track 45 degrees

code	product
OHTNP-45NT	45 degree bend (internal)
OHTNP-45EXT	45 degree bend (external)

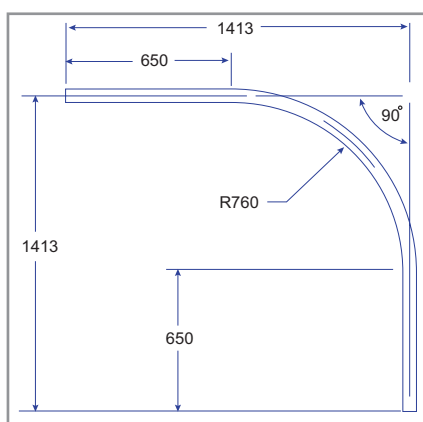

Curved track 90 degrees

code	product
OHTNP-90INT	90 degree bend (internal)
OHTNP-90EXT	90 degree bend (external)

X-Y TO MONO SYSTEMS

The X-Y to Mono transfer system maximises room coverage, reducing the need for manual handling of clients. The system is configured to connect an X-Y system to a mono track, allowing the hoist to travel through a doorway and to other rooms or to join another X-Y system.

Notes: With all XY-Mono systems it is necessary to specify piggy back for use on the moving XY beam.

The XY-Mono cassettes shown below should be ordered in addition to the normal track, piggy back, XY trolleys, buzz bar and fixing components.

Chiltern Invadex X-Y to Mono systems can be configured to suit specific client requirements. A number of typical scenarios are shown below. Please contact Customer Service for specific details or to arrange a visit by a Technical Sales Representative.

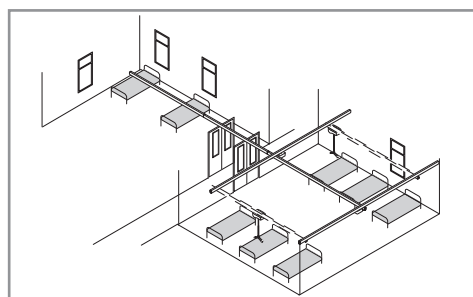

X-Y to mono

- Travel from moving X-Y beam on to a fixed mono track

code	product
310-00093	X-Y to Mono Assembly (RH X-Y cassette & LH mono cassette)
or	
310-00094	X-Y to Mono Assembly (LH X-Y cassette & RH mono cassette)

SYMBOLS: Bulk item
Made to order
Anti-microbial coating
(see P68 for details)



Tel: 01869 365500 Email: sales@chilterninvadex.co.uk
www.chilterninvadex.co.uk

X-Y TO MONO SYSTEMS

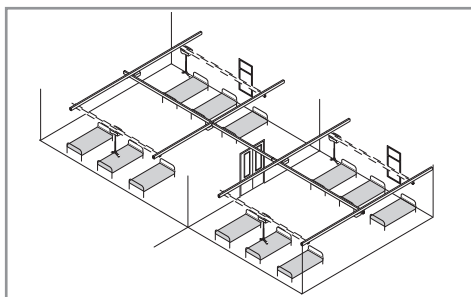

X-Y to mono to X-Y (short length)

- Travel from moving X-Y beam onto short length of fixed track, typically through a doorway and onto another moving X-Y beam.
- Mono track less than 2.5m length

code	product
310-00092	X-Y to Mono to X-Y Assembly (RH X-Y cassette, double ended mono cassette, LH X-Y cassette)

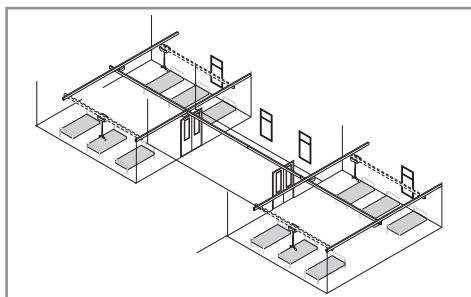

X-Y to mono to X-Y (extended length)

- Travel from moving X-Y beam, onto an extended length of fixed track typically down a corridor and onto another moving X-Y track

code	product
310-00093	X-Y to Mono Assembly (RH X-Y cassette & LH mono cassette)
and	
310-00094	X-Y to Mono Assembly (LH X-Y cassette & RH mono cassette)

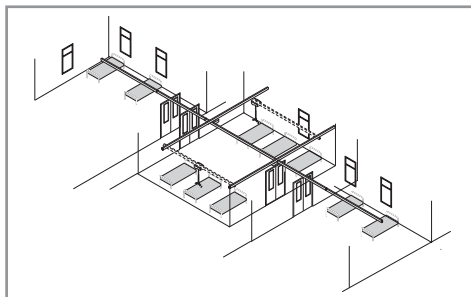

Mono to X-Y to mono

- Travel from fixed track onto moving X-Y beam and off to another fixed track

code	product
310-00093	X-Y to Mono Assembly (RH X-Y cassette & LH mono cassette)
and	
310-00094	X-Y to Mono Assembly (LH X-Y cassette & RH mono cassette)

A detailed Specifiers Guide is available to Architects and scheme specifiers. Please call customer services on 01869 365500 to obtain a copy



MOBILE HOISTS



Wispa mobile

Maximum Load 158kg (25 stones) (347lb)

- Extensive lifting range
- Emergency lowering
- Easy steer
- Quiet, smooth action
- Battery pack is neat, unobtrusive and simple to recharge when not in use
- Up to 100 lifts from one charge means long periods between recharging
- Compatible with the Chiltern Invadex range of patient handling slings

code	product	power	function
MHWMEHLUKEL	Wispa Mobile	Battery	High Lift

Wispa mobile hoist range Technical information

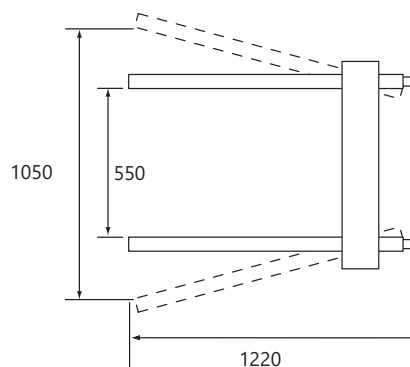
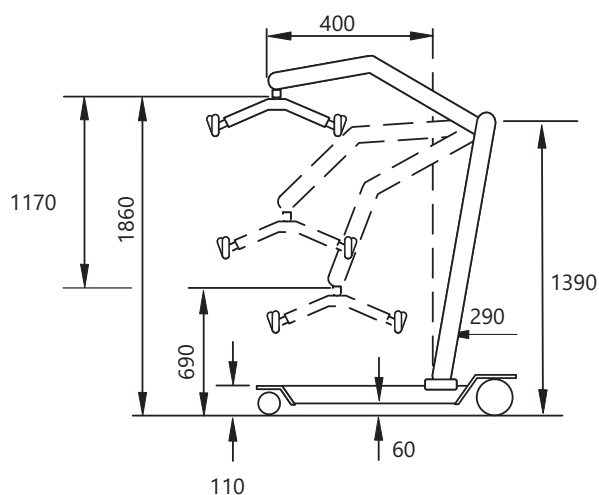



SLINGS

Bespoke models available refer to page 32

SYMBOLS: Bulk item
Made to order
Anti-microbial coating
(see P68 for details)



Tel: 01869 365500 Email: sales@chilterninvadex.co.uk
www.chilterninvadex.co.uk

WISPA UNIVERSAL SLINGS

A. Select your sling

SLU

Universal Sling

- Good support for legs, shoulders and back
- Easy to fit and remove with slide sheet material on rear of legs
- Four fabric options
- Positioning handles and pocket on reverse
- Commode aperture for toileting



SLUD

Full Support Universal Deluxe

- Good support for legs, shoulders, back and head
- Shaped, padded head support
- Easy to fit and remove with slide sheet material on rear of legs
- Four fabric options
- Positioning handles and pocket on reverse
- Commode aperture for toileting



B. Select your fabric

- 1 Quilted Polyester
- 2 Unquilted Polyester



Polyester

A hardwearing close weave fabric. Providing a comfortable smooth finish. Quilted and unquilted options.

Safe working load: 400kg

- 3 Quilted Royal Net
- 4 Unquilted Royal Net

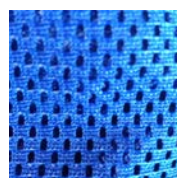

Royal Net

Ideal for bathing, the Royal Net material has thousands of tiny drainage holes. Quilted and unquilted options.

Safe working load: 300kg

- 5 3D Spacer

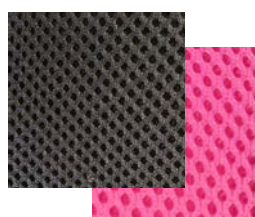

3D Spacer

State of the art material which adapts to the shape of the users body. Used for in-situ slings the fabric offers pressure relief, heat dispersion and moisture wicking properties.

Safe working load: 300kg

- 6 Parachute



Parachute

Silky, soft material which is light and provides little friction during application/removal of the sling.

Safe working load: 200kg



WISPA UNIVERSAL SLINGS

C. Select your size

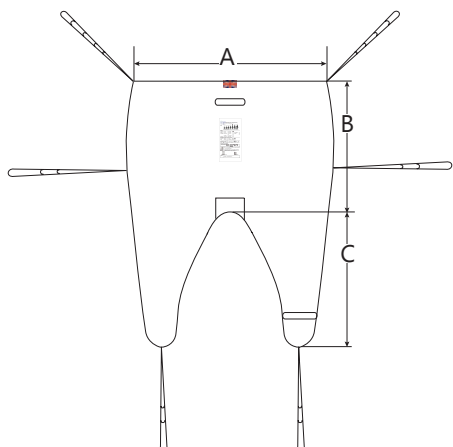

Size	A	B	C
P3	550	390	280
P2	590	410	310
P1	690	470	410
XS	770	490	450
S	860	560	530
M	1040	640	610
L	1160	670	640
XL	1290	700	690

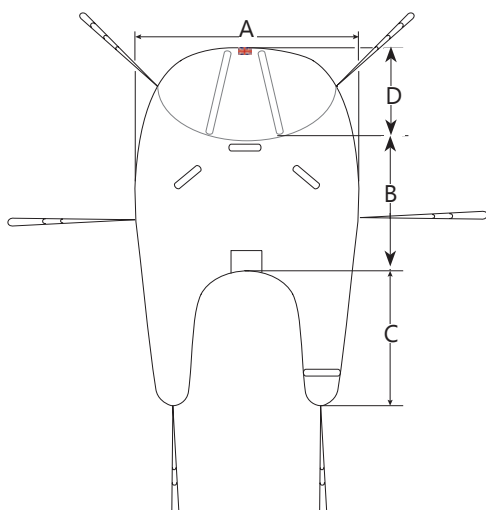

Size	A	B	C	D
P3	550	300	350	250
P2	580	330	380	270
P1	660	390	460	290
XS	730	470	490	310
S	860	530	550	310
M	960	600	610	410
L	1060	670	640	410
XL	1110	710	670	410

D. Complete your order code

Sling model

Fabric Number

—

Size

See page 32 for special features

Example: Universal deluxe sling required in 3D spacer material, size M

Sling model

Fabric Number

—

Size



WISPA HAMMOCK SLINGS

A. Select your sling

SLSH

Standard Hammock/Amputee Sling

- Excellent support for head/neck, shoulders, back, hips, buttocks and thighs
- Support for upper thigh and hip means that the sling is suitable for hoisting clients with above knee amputations
- Unquilted
- Available with toileting aperture - to special order



SLCH

Classic Hammock Sling

- Designed to provide a comfortable lift and reduce hip movement
- Toileting aperture
- Slide sheet material on rear of legs to aid fitting & reduce friction
- Available with head support - to special order



B. Select your fabric

1 Quilted Polyester (SLCH model only)

2 Unquilted Polyester



Polyester

A hardwearing close weave fabric. Providing a comfortable smooth finish. Quilted and unquilted options.

Safe working load: 400kg

3 Quilted Royal Net (SLCH model only)

4 Unquilted Royal Net

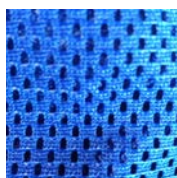

Royal Net

Ideal for bathing, the Royal Net material has thousands of tiny drainage holes. Quilted and unquilted options.

Safe working load: 300kg

5 3D Spacer

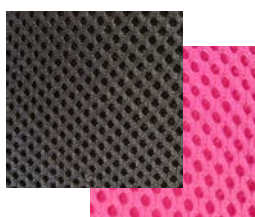

3D Spacer

State of the art material which adapts to the shape of the users body. Used for in-situ slings the fabric offers pressure relief, heat dispersion and moisture wicking properties.

Safe working load: 300kg

6 Parachute



Parachute

Silky, soft material which is light and provides little friction during application/removal of the sling.

Safe working load: 200kg



WISPA HAMMOCK SLINGS

C. Select your size

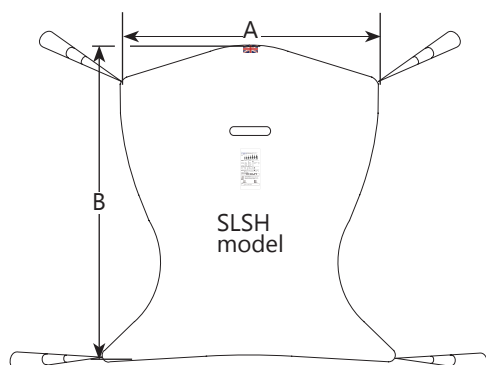

Size	A	B
XS	810	1040
S	860	1090
M	960	1140
L	1060	1220
XL	1160	1290

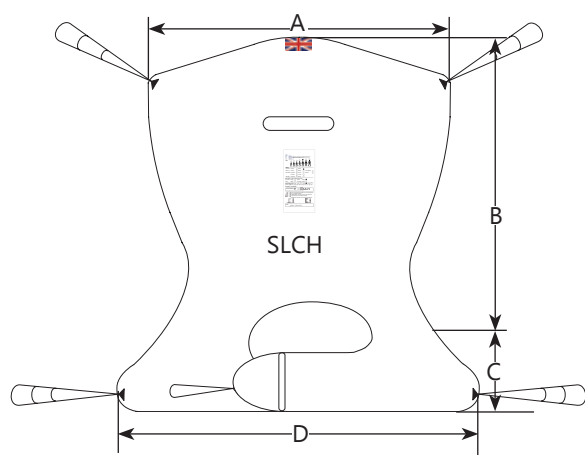

Size	A	B	C	D
P	690	480	300	480
XS	770	520	330	530
S	860	580	330	580
M	960	680	370	680
L	1060	730	400	750
XL	1160	730	470	750

D. Complete your order code

Sling model

Fabric Number

-

Size

See page 32 for special features

Example: Classic hammock sling required in quilted polyester, size XL

Sling model

Fabric Number

-

Size



WISPA HAMMOCK SLINGS

A. Select your sling

SLDH

Deluxe Hammock Sling

- Offers secure, comfortable fit around the hips.
- Toileting aperture
- Slide sheet material on rear of legs to aid fitting & reduce friction
- Rear positioning pocket
- Available with head support - to special order



SLEH

Extensor Hammock Sling

- Offers secure, comfortable fit around the hips
- Comfortable shaped and padded head support
- Toileting aperture
- Slide sheet material on rear of legs to aid fitting & reduce friction
- Rear positioning pocket



SLICH/SLICS



In-Chair Hammock Sling (Fabric 5 only)

- Manufactured from spacer material, the fabric moulds to the shape of the user, allows for air circulation reducing the build up of heat and has moisture wicking properties.
- Shaped to sit snugly into a chair
- Strap pockets to tuck away lifting straps when not in use
- Pommel for added security
- Pommel (SLICH) or split leg (SLICS)



B. Select your fabric

1 Quilted Polyester

2 Unquilted Polyester

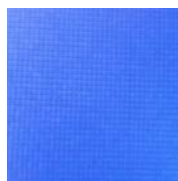

Polyester

A hardwearing close weave fabric. Providing a comfortable smooth finish. Quilted and unquilted options.

Safe working load: 400kg

3 Quilted Royal Net

4 Unquilted Royal Net

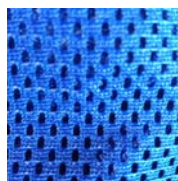

Royal Net

Ideal for bathing, the Royal Net material has thousands of tiny drainage holes. Quilted and unquilted options.

Safe working load: 300kg

5 3D Spacer

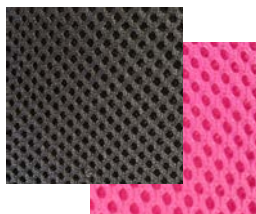

3D Spacer

State of the art material which adapts to the shape of the users body. Used for in-situ slings the fabric offers pressure relief, heat dispersion and moisture wicking properties.

Safe working load: 300kg

6 Parachute



Parachute

Silky, soft material which is light and provides little friction during application/removal of the sling.

Safe working load: 200kg



WISPA HAMMOCK SLINGS

C. Select your size

Size	A	B	C
P	690	480	480
XS	770	520	530
S	860	580	580
M	960	680	680
L	1160	730	750
XL	1290	730	750

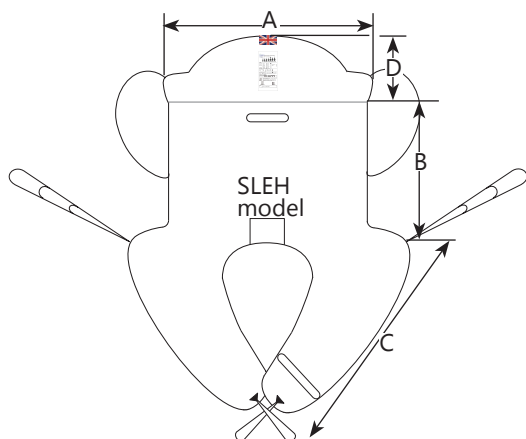
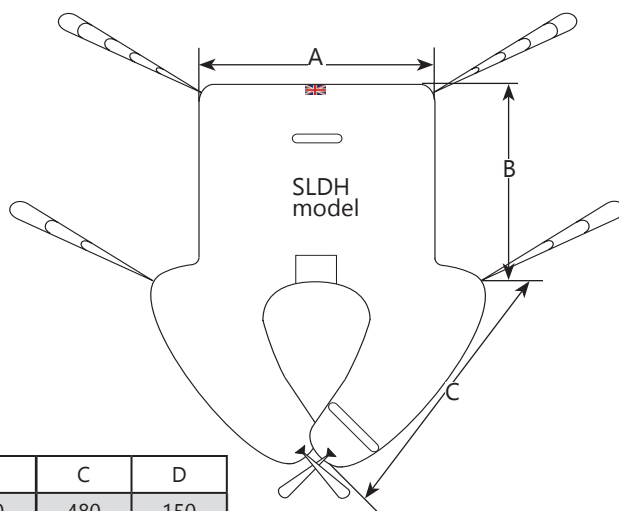

Size	A	B	C	D
P	690	480	480	150
XS	770	520	530	160
S	860	580	580	170
M	960	680	680	180
L	1160	730	750	190
XL	1290	730	750	200

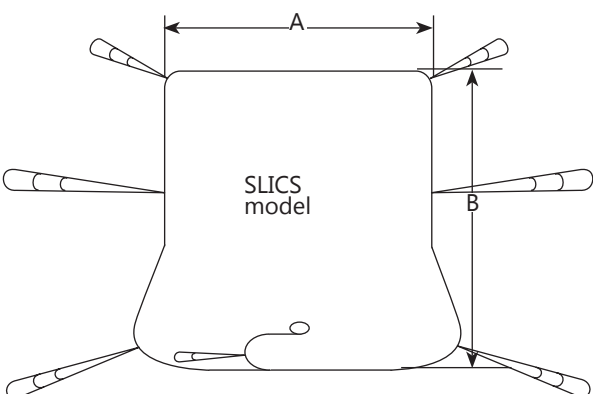

Size	A	B
P3	590	750
P2	640	820
P1	690	850
XS	770	890
S	860	960
M	960	1060
L	1160	1150
XL	1290	1180

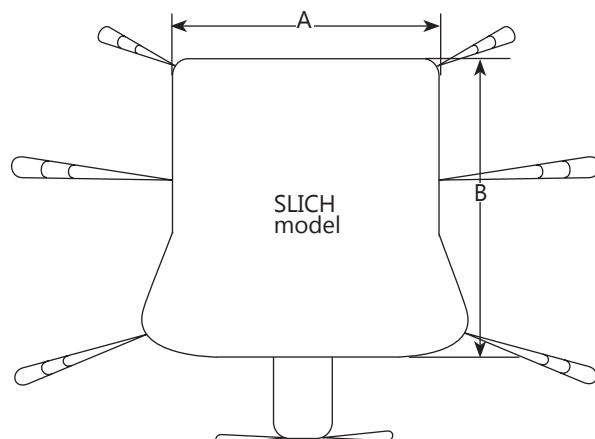

D. Complete your order code

Sling model

Fabric Number

—

Size

See page 32 for special features

Example: Extensor hammock sling required in unquilted royal net, size S

Sling model

Fabric Number

—

Size



WISPA TOILETING/ACCESS SLINGS

A. Select your sling

SLCT

Classic Toileting/Access Sling

- Offers secure, comfortable fit with large aperture to aid the removal/adjustment of clothing
- Adjustable waist strap
- Slide sheet material on rear of legs to aid fitting & reduce friction
- Fully padded



SLDT

Deluxe Toileting/Access Sling

- Offers secure, comfortable fit with large aperture to aid the removal/adjustment of clothing
- Comfortable head support
- Extensor straps
- Adjustable waist strap
- Slide sheet material on rear of legs to aid fitting & reduce friction
- Fully padded



SLFST

Full Support Toileting/Access Sling

- Offers a greater degree of security for those who may lack the upper body strength to use a classic toileting sling
- High back and cross over strap design allows for the users arms to remain safely inside the sling during use.
- Wide padded legs
- Self tightening straps
- Slide sheet material on rear of legs to aid fitting & reduce friction

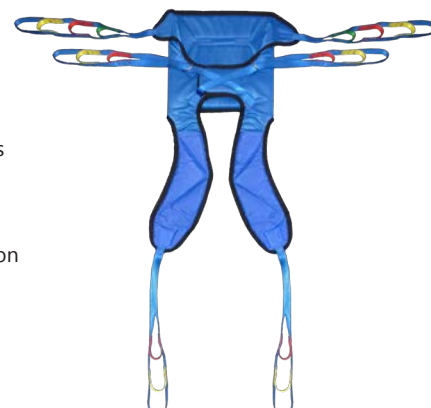

Note: toileting slings require the user to have a degree of upper body strength

B. Select your fabric

1 Quilted Polyester

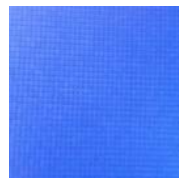

Polyester

A hardwearing close weave fabric. Providing a comfortable smooth finish. Quilted and unquilted options.

Safe working load: 400kg

3 Quilted Royal Net

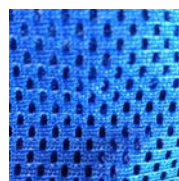

Royal Net

Ideal for bathing, the Royal Net material has thousands of tiny drainage holes. Quilted and unquilted options.

Safe working load: 300kg



WISPA TOILETING/ACCESS SLINGS

C. Select your size

Size	A	B	C	D
P2	480	220	550	960
P1	530	250	580	1060
XS	700	310	670	1220
S	820	370	820	1320
M	910	390	840	1370
L	1010	390	870	1420
XL	1110	410	890	1520

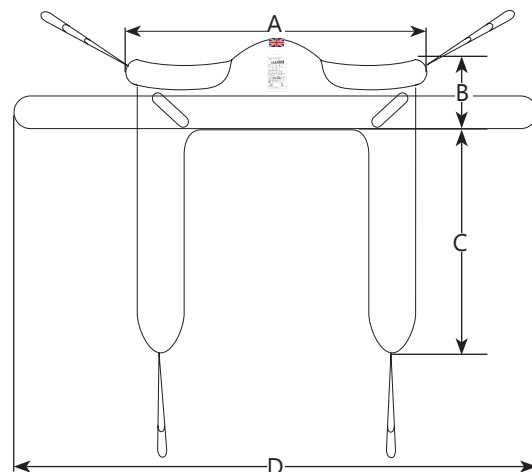

Size	A	B	C	D	E
P2	480	220	550	300	960
P1	530	250	580	320	1060
XS	700	310	670	350	1220
S	700	370	820	370	1320
M	910	390	840	370	1370
L	1010	390	870	400	1420
XL	1110	410	890	400	1520

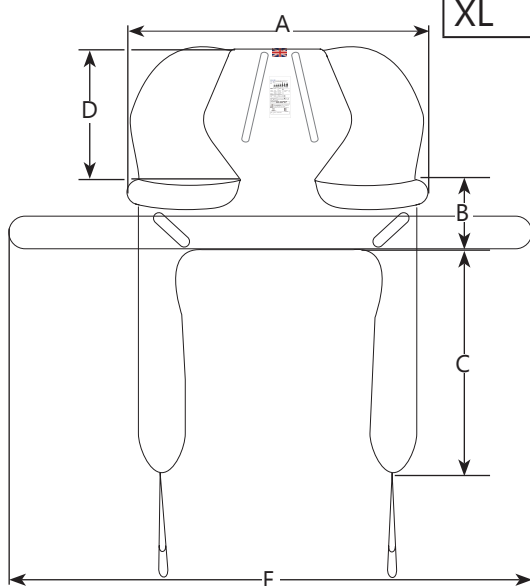

Size	A	B	C
P2	590	360	450
P1	650	400	480
XS	710	430	510
S	800	450	610
M	900	500	670
L	1000	530	770
XL	1100	560	840

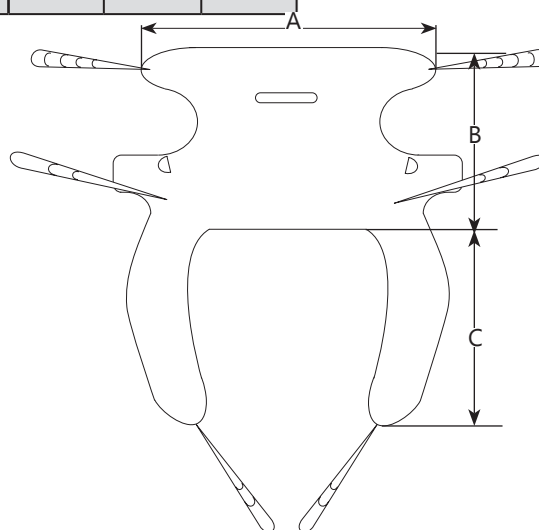

D. Complete your order code

Sling model

Fabric Number

-

Size

See page 32 for special features

Example: Deluxe toileting sling required in polyester, size P

Sling model

Fabric Number

-

Size

SYMBOLS: Bulk item
Made to order
Anti-microbial coating
(see P68 for details)



Tel: 01869 365500 Email: sales@chilterninvadex.co.uk
www.chilterninvadex.co.uk

SPECIAL FEATURES

Our highly experienced, surveying and manufacturing teams are able to competently design and create bespoke slings to meet individual user requirements. All slings are manufactured in the UK, as such slings with special features can be manufactured in around 14 days. Should a survey be required, please call our customer services team for a no charge, no obligation visit on 01869 365500 opt 1.

Below are details of the most frequently requested special features. Should you require elements which are not listed, please do not hesitate to contact our technical team to discuss feasibility.

Part number	Special feature
SLSSP	Simulated sheepskin - part lining
SLSSF	Simulated sheepskin - full lining
SLTTP	Terry towelling - part lining
SLTTF	Terry towelling - full lining
SLPFP	Polar fleece - part lining
SLPFF	Polar fleece - full lining
SLCP*	Character fabric - part lining
SLCF*	Character fabric - full lining
SLBELT	Body belt
SLCLIP	Clip fastening
SLHS	Add or remove head support
SLDC	Dimension change (per sling) - drawing to be provided**

*Character fabric patterns vary, please call for details of current stock. Available on paediatric models only.

**Please contact us for specification form

Ordering Instruction

Select the required standard sling model from pages 24-31

Sling model	Fabric Number	Size
<input type="text"/>	<input type="text"/> - <input type="text"/>	<input type="text"/>

Add required special feature codes;

Special feature references

<input type="text"/>	<input type="text"/>	<input type="text"/>
----------------------	----------------------	----------------------

Example: Universal sling, polyester, paediatric 1, part character lining and body belt.

Sling model	Fabric Number	Size
<input type="text" value="SLU"/>	<input type="text" value="1"/> - <input type="text" value="P1"/>	<input type="text"/>

Special feature references

<input type="text" value="SLCP"/>	<input type="text" value="SLBB"/>	<input type="text"/>
-----------------------------------	-----------------------------------	----------------------

SYMBOLS: Bulk item

Made to order

Anti-microbial coating

(see P68 for details)



Tel: 01869 365500 Email: sales@chilterninvadex.co.uk

www.chilterninvadex.co.uk

DISPOSABLE SLINGS/PATIENT SPECIFIC



Patient Specific Full Back Disposable Sling Maximum Load 227kg (35 stones)

- Designed to stay with the client
- Reduced cross infection risk
- A cost effective solution
- Readily available
- Good support for legs, shoulders, back and head for a safe and comfortable lift
- Strong, lightweight and durable

code	product	size
SLD001-S	Patient Specific Sling	Small (box of 10)
SLD001	Patient Specific Sling	Medium (box of 10)
SLD001-L	Patient Specific Sling	Large (box of 10)

Technical Information

Size & Weight Range Guide (approx.)

This chart provides only an approximate indication of sling size based on patient weight. A full risk assessment is recommended to ascertain the most suitable size of sling based on patient's measurements and conditions rather than weight alone.

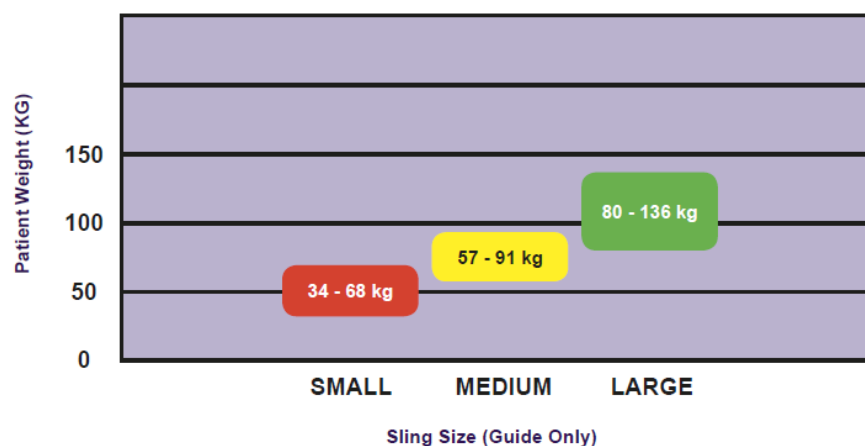

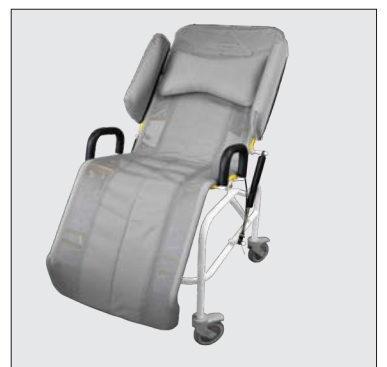

SHOWER CHAIRS
SHOWER TROLLEYS & STRETCHERS
SHOWER CRADLES
PAEDIATRIC RANGE

SHOWER CHAIRS - TRANSAQUA

The TransAqua range of shower commode chairs has been developed to provide a modular bathing and toileting solution which can be easily adapted to alter with the user. The chairs innovative modular design allows each component to be retrospectively replaced as the users needs change or to facilitate re-issue. Seats, armrests and footrests are interchangeable, the width of the frame can be increased/decreased* and the chair can be converted from self propelled to attendant propelled and vice versa. Height adjustable by the use of extension pins (available to order) by 25mm or 50mm reducing the need for a replacement frame.

* replacement backrest, cross member and seat required.

Main Features

- Safe working load 200kg (31st) (440lb)
- The chair features a stainless steel frame with corrosion resistant wheels and castors.
- Armrests and footrests swing away to aid transfer.
- Several footrest options are available, each is height adjustable to ensure that the user is in a comfortable position.
- Seats are available as flat padded, full ring aperture or horseshoe with a range of aperture sizes to suit the user.
- Can be used over a toilet or provided with a commode pan and cradle.
- 19" and 21" chairs are Clos-o-mat compatible.
- Self propelled models can be provided with 20", 22" or 24" wheels.
- Attendant propelled models are provided with four braked castors, directional locking castor available on request.

Self Propelled



Attendant Propelled



Self propelled Models

code	product	seat options
TA18SP	TransAqua Self Propelled	Horseshoe, Aperture, Flat Padded Seat 18" (450mm)
TA19SP*	TransAqua Self Propelled	Horseshoe, Aperture, Flat Padded Seat 19" (487mm)
TA21SP*	TransAqua Self Propelled	Horseshoe, Aperture, Flat Padded Seat 21" (537mm)

Attendant propelled Models

code	product	seat options
TA18AP	TransAqua Attendant Propelled	Horseshoe, Aperture, Flat Padded Seat 18" (450mm)
TA19AP*	TransAqua Self Propelled	Horseshoe, Aperture, Flat Padded Seat 18" (450mm)
TA21AP*	TransAqua Attendant Propelled	Horseshoe, Aperture, Flat Padded Seat 21" (537mm)

* 19" and 21" TransAqua chairs are Closomat compatible, a seat skirt should be requested at time of order. See also AquaMaster C range for alternative Closomat compatible chair page 39.

TransAqua Shower chair optional extras

selection

Commode Pan Cradle & Fittings (Not suitable for use with Padded Flat Seat)
Commode Pan
Seat extended by 50mm
Increase seat height by 25mm
Chair supplied assembled
Seat skirt to suit Closomat Automatic Toilet

The complete range of accessories is shown on pages 37. For spare parts refer to customer services on 01869 365500 Opt 1

Chiltern Invadex shower chairs are available with a large range of options and accessories, allowing the chair to be configured to suit specific client requirements. An electronic codebreaker and quick order form are available to help select the appropriate standard options. Please contact Customer Service for details or to arrange a demonstration visit by a Technical Sales Representative.



SHOWER CHAIRS - TRANSAQUA

Technical information

Self propelled

Note: Dimensions are for guidance only. Self propelled dimensions are based on a 22" diameter wheel.

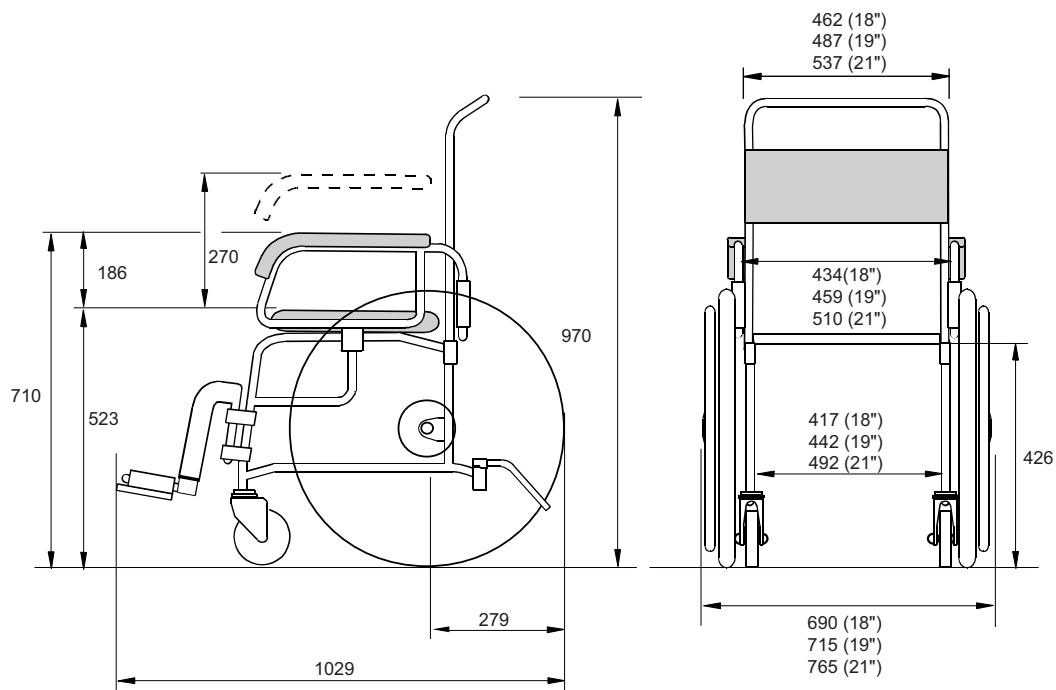

Attendant propelled

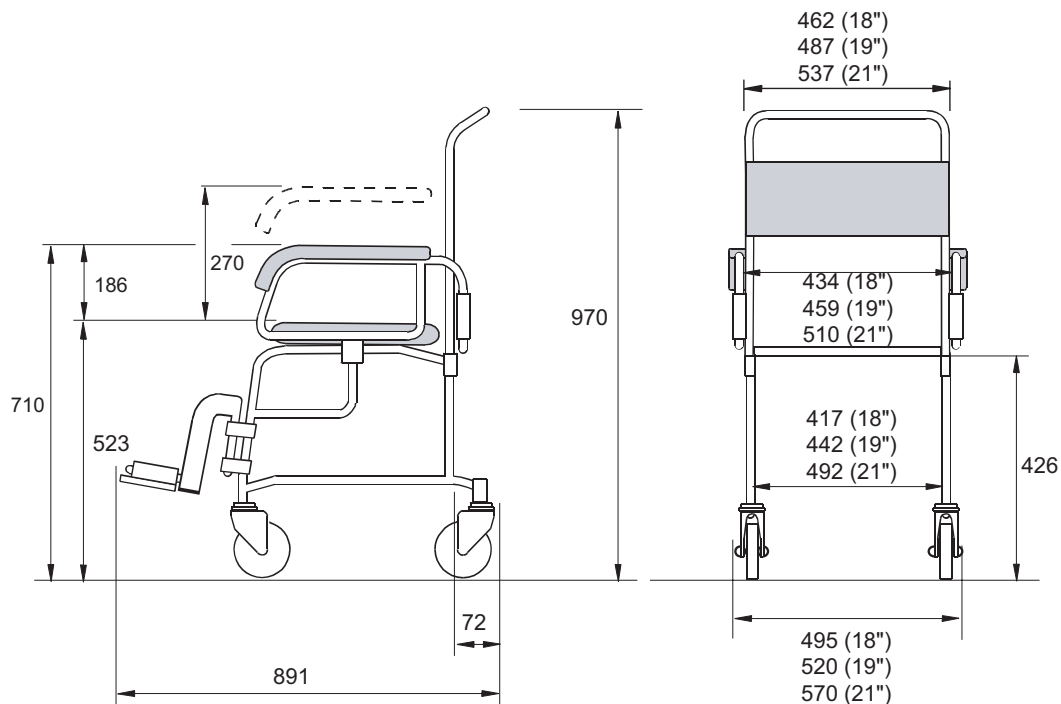

If a bespoke chair is required, please refer to the AquaMaster range on page 38.

SYMBOLS: Bulk item
Made to order
Anti-microbial coating
(see P68 for details)



Tel: 01869 365500 Email: sales@chilterninvadex.co.uk
www.chilterninvadex.co.uk

SHOWER CHAIRS - TRANSAQUA

TransAqua shower chair accessories

NOTE: Left hand and right hand are always determined as sitting in chair

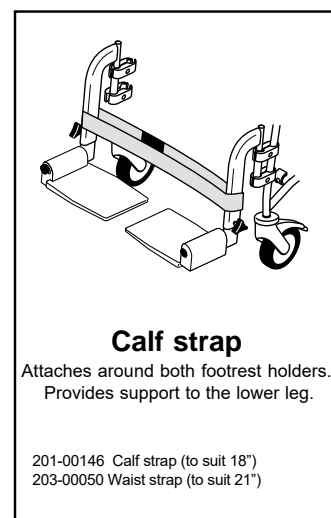
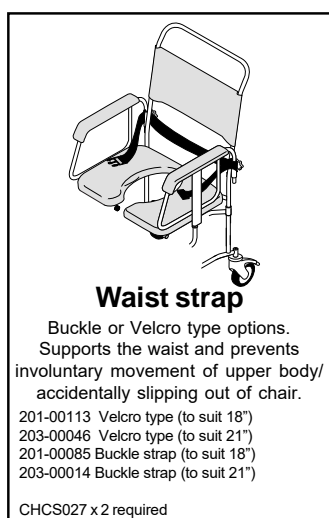
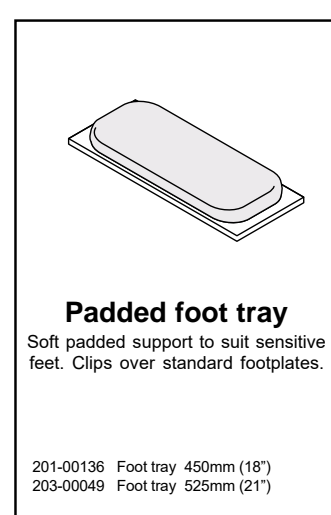
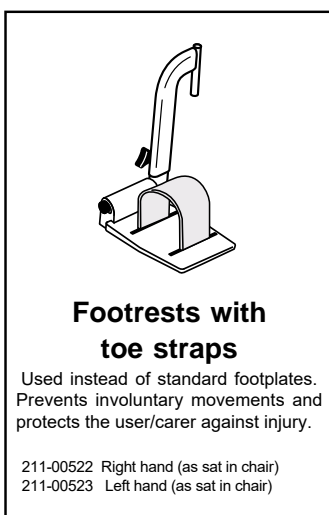
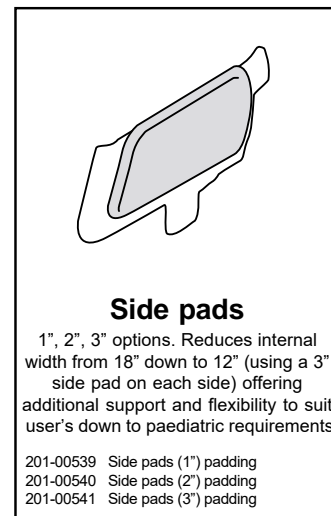
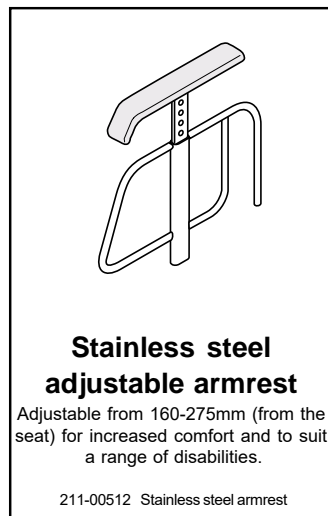
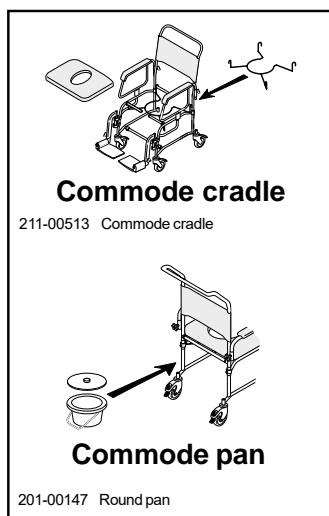

For spare parts, please refer to customer services on 01869 365500 opt 1.

SYMBOLS: Bulk item
Made to order
Anti-microbial coating
(see P68 for details)



Tel: 01869 365500 Email: sales@chilterninvadex.co.uk
www.chilterninvadex.co.uk

SHOWER CHAIRS - AQUAMASTER



The AquaMaster range of shower commode chairs provides a rigid one piece base frame with modular elements to allow easy replacement of components to suit the users changing needs. Seats, armrests and footrests which are interchangeable. The chair also features a wide range of accessories (see pages 43-44) and is available as a made to measure piece of equipment, specially manufactured at our Oxfordshire facility to meet individual needs. The coated frame features an anti-microbial element which is proven to destroy 99.9% of harmful bugs including MRSA.

Main Features

- Safe working load 200kg (31st) (440lb)
- The chair features a rigid one piece base frame.
- Removeable armrests and footrests swing away to aid transfer.
- Several footrest options are available, each is height adjustable to ensure that the user is in a comfortable position.
- Seats are available as flat padded, full ring aperture, horseshoe or side access with a range of aperture sizes to suit the user.
- Options extended seats and pressure relief foam.
- Can be used over a toilet or provided with a commode pan and cradle.
- Self propelled models can be provided with 20", 22" or 24" wheels.
- Attendant propelled models are provided with four braked castors, directional locking castor available on request.
- Static model can be used over a toilet, in a shower or as a bedside commode with the addition of a commode pan and support.
- Each model can be manufactured as a bespoke, user specific model (subject to site survey) - see page 42 for special features list

A02 Static



A06 Attendant Propelled



A08 Self Propelled



A11 Self Propelled



Static Models

code	product	description
A02	AquaMaster Static Shower Chair	Horseshoe, Aperture, Flat Padded Seat 17" (445mm)
A02	AquaMaster Static Shower Chair	Horseshoe, Aperture, Flat Padded Seat 19" (480mm)
A02	AquaMaster Static Shower Chair	Horseshoe, Aperture, Flat Padded Seat 21" (545mm)

Attendant Propelled Models

code	product	description
A06	AquaMaster Attendant Propelled	Horseshoe, Aperture, Flat Padded Seat 17" (445mm)
A06	AquaMaster Attendant Propelled	Horseshoe, Aperture, Flat Padded Seat 19" (480mm)
A06	AquaMaster Attendant Propelled	Horseshoe, Aperture, Flat Padded Seat 21" (545mm)

Self Propelled Models

code	product	description
A08	AquaMaster Self Propelled	Horseshoe, Aperture, Flat Padded Seat 17" (445mm)
A08	AquaMaster Self Propelled	Horseshoe, Aperture, Flat Padded Seat 19" (480mm)
A08	AquaMaster Self Propelled	Horseshoe, Aperture, Flat Padded Seat 21" (545mm)

code	product	description
A11	AquaMaster Self Propelled	Horseshoe, Aperture, Flat Padded Seat 17" (445mm)
A11	AquaMaster Self Propelled	Horseshoe, Aperture, Flat Padded Seat 19" (480mm)
A11	AquaMaster Self Propelled	Horseshoe, Aperture, Flat Padded Seat 21" (545mm)

For Paediatric range see page 57

For Bariatric range see page 41

For technical information refer to page 40.



SHOWER CHAIRS - AQUAMASTER C RANGE



clos^omat™

Designed in conjunction with Clos-o-mat, the AquaMaster C range of shower chairs has all of the main features of the popular AquaMaster range, re-developed to complement the Palma Vita automatic toilet.

- Perfectly proportioned to suit the Clos-o-mat Palma Vita, including level seat and pram handle backrest
- Skirted seat provided as standard
- Bariatric bench has a safe working load of 55st

A02C Bariatric Bench



A06C Attendant Propelled



A11C Self Propelled



Static Bench Models

code	product	description
A02C	Bariatric bench	Horseshoe, Aperture, 24" (600mm)
A02CSPEC	Bariatric bench	Complete with arms and backrest
Floor fixing kit for permanent fixing available, please call for details		

Attendant Propelled Models

code	product	description
A06C	AquaMaster Attendant Propelled	Horseshoe or Aperture seat 17" (445mm)
A06C	AquaMaster Attendant Propelled	Horseshoe or Aperture seat 19" (480mm)
A06C	AquaMaster Attendant Propelled	Horseshoe or Aperture seat 21" (545mm)

Self Propelled Models

code	product	description
A11C	AquaMaster Self Propelled	Horseshoe or Aperture seat 17" (445mm)
A11C	AquaMaster Self Propelled	Horseshoe or Aperture seat 19" (480mm)
A11C	AquaMaster Self Propelled	Horseshoe or Aperture seat 21" (545mm)

For technical information refer to page 40.

SYMBOLS: Bulk item
Made to order
Anti-microbial coating
(see P68 for details)



Tel: 01869 365500 Email: sales@chilterninvadex.co.uk
www.chilterninvadex.co.uk

SHOWER CHAIRS - AQUAMASTER

A02 Static Chair

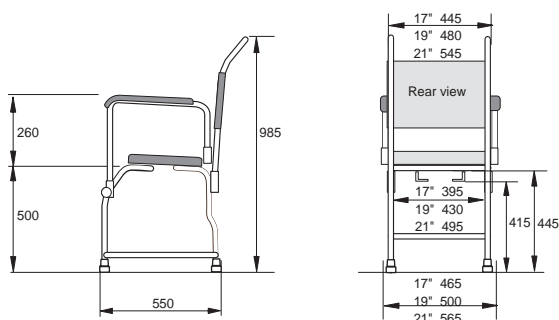

A02C Bariatric Bench

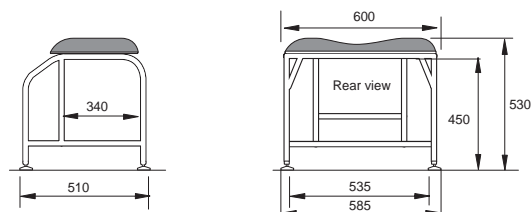

A06 Attendant Propelled Chair

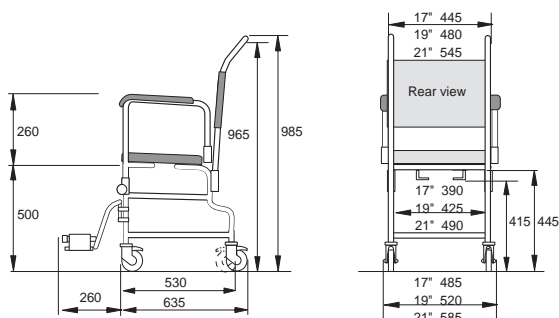

A06C Attendant Propelled Chair

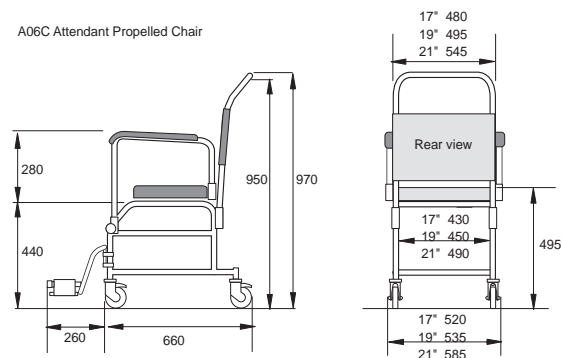

A08 Self Propelled Chair

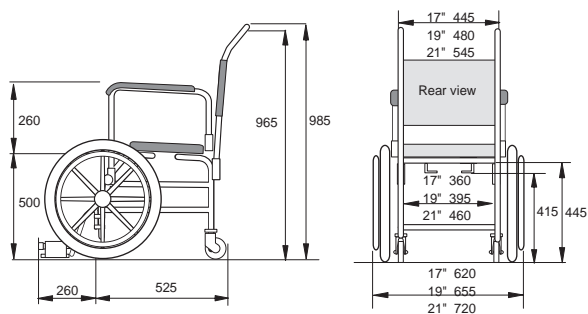

A11 Self Propelled Chair

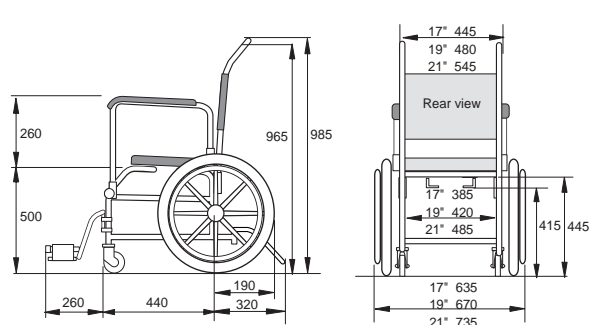

A11C Self Propelled Chair

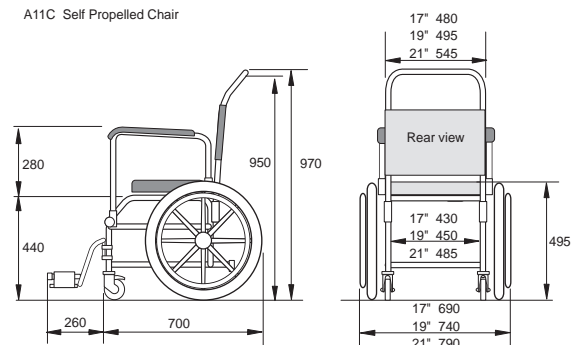

SYMBOLS: Bulk item
Made to order
Anti-microbial coating
(see P68 for details)



Tel: 01869 365500 Email: sales@chilterninvadex.co.uk
www.chilterninvadex.co.uk

SHOWER CHAIRS - AQUAMASTER BARIATRIC (TO SPECIAL ORDER)



The AquaMaster A13 is a bariatric version of the popular A06 attendant propelled shower chair, redesigned for the requirements of bariatric clients. Part of the AquaMaster shower chair range it features a rigid one piece frame with interchangeable seat, backrest, arm and footrest options.

Seat, backrest padding and armrest pads are manufactured with the use of pressure relief foam to aid comfort when seated at no additional cost (a vinyl backrest fabric can be supplied if the pad is not required)

Heavy duty twin wheeled castors and heel straps fitted to each removable and height adjustable footplate help to aid both user and care teams to provide comfort and security when in use, a full length close cell foam grip allows the chair to be manoeuvred comfortably when in use.

- Safe working load of 55st
- Rigid one piece frame
- Pressure relief foam
- Large castors
- Padded, comfortable push handle
- Large horseshoe seat as standard, large aperture and flat padded available on request.

Attendant Propelled Model only

code	product	description
A13	AquaMaster Bariatric Chair	Horseshoe seat as standard

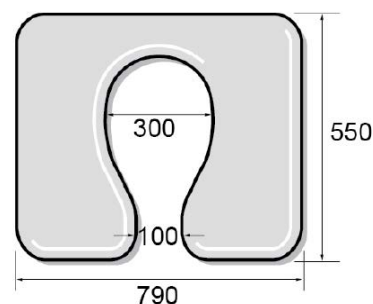
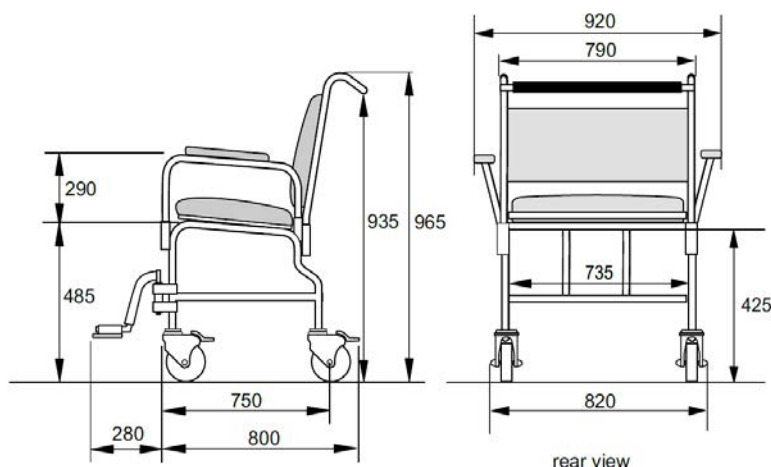

To special order only, a visit from one of our surveyors is highly recommended. Please contact customer services to arrange a joint visit on 01869 365500 opt 1.

SYMBOLS: Bulk item
Made to order
Anti-microbial coating
(see P68 for details)



Tel: 01869 365500 Email: sales@chilterninvadex.co.uk
www.chilterninvadex.co.uk

SHOWER CHAIRS - AQUAMASTER

AquaMaster Chair Special Features



selection	description
Chair width	Available in custom widths
Height	Raise or lower seat height (maximum increase +150mm/6")
Backrest options	Additional recline (upto10 degrees)
	Additional recline (over 10 degrees)
	Height change
	Full height backrest material
	Full height backrest fabric (mesh)
	Backrest cushion (state thickness - 25, 50 or 75mm/ 1", 2" or 3")
Seat options	Non standard seat
	Seat skirt* (for padded horseshoe and padded aperture seats only)
	Extra padding (maximum +25mm/+1")
	Reduced or no padding
	Dartex seat covering
	Side access seat extension by 50mm or 75mm
	Change aperture dimension
	Pressure relief foam
* supplied as standard on Clos-o-mat chairs (A02C, A06C & A11C)	
Armrest options	Height increased or lowered
	Length change
	Pair special soft pads
	Pair padded armrests (25, 50 or 75mm/ 1", 2" or 3")
	Pair gutter channel armrests
	Front safety bar (includes special armrests)
	Cranked armrests
	Bolted in armrests
Footrest options	Change footrest angle
	Double length footplate (pair)
	Velcro padding (per footrest)
	Raise footrest height
	Stump support (fixed, each)

The above list shows the most commonly requested special features, additional items are available please call customer services to discuss specific requirements on 01869 365500 opt 1.

See also the standard range of accessories on pages 43-44



SHOWER CHAIRS

AquaMaster shower chair accessories

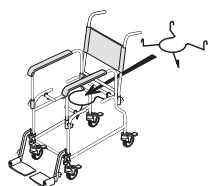

Commode cradle

CHCS3020 Commode cradle



Commode pan

201-00147 Round pan

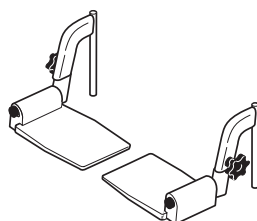

Short Footrests

Used instead of standard footrests where feet require support at a higher level (18 and 90 degree options).

18 Degree

211-00528 Left hand (as sat in chair)
211-00529 Right hand (as sat in chair)

90 Degree

211-00530 Left hand (as sat in chair)
211-00531 Right hand (as sat in chair)

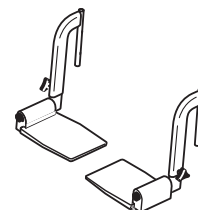

90 degree footrests

Use instead of standard footrests, where space is limited, or if the users posture requires feet to be positioned closer to the chair frame

211-00526 90 degree footrests (LH)
211-00527 90 degree footrests (RH)

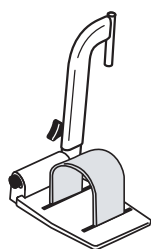

Footrests with toe straps

Used instead of standard footplates. Prevents involuntary movements and protects the user/carer against injury.

211-00523 Left hand (as sat in chair)
211-00522 Right hand (as sat in chair)

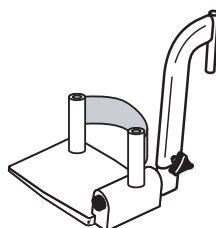

Footrests with heel straps

Provides additional support for feet. Prevents the user from slipping off the back and falling forwards.

211-00521 Left hand (as sat in chair)
211-00520 Right hand (as sat in chair)

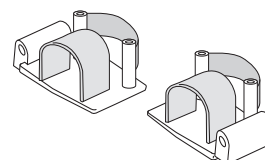

Footrests with heel straps/toe straps

Provides total support of feet against involuntary movement

211-00525 Footrests c/w heel & toe (LH)
211-00524 Footrests c/w heel & toe (RH)

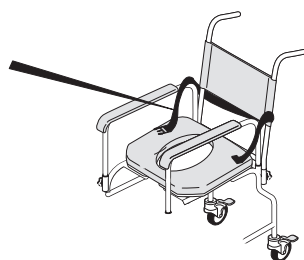

Waist strap

Buckle or Velcro type options. Supports the waist and prevents involuntary movement of upper body/ accidentally slipping out of chair.

201-00113 Velcro type (standard/19" chairs)
203-00046 Velcro type (to suit wider chairs)
201-00085 Buckle strap (standard/19" chairs)
203-00014 Buckle strap (to suit wider chairs)

CHCS027 x 2 required



Full support harness

Prevents involuntary movement of upper body/accidentally slipping out of chair.

201-00143 (to suit all chairs)

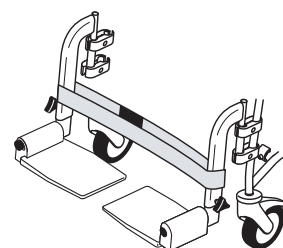

Calf strap

Attaches around both footrest holders. Provides support to the lower leg.

201-00146 Calf strap (to suit standard/19" chair)
203-00050 Calf strap (to suit wider chairs)

SYMBOLS: Bulk item

Made to order

Anti-microbial coating

(see P68 for details)



Tel: 01869 365500 Email: sales@chilterninvadex.co.uk

www.chilterninvadex.co.uk

SHOWER CHAIRS

AquaMaster shower chair accessories

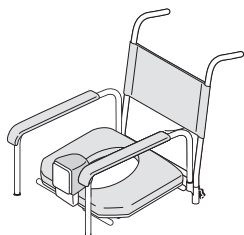

Pommel

Fitted to the front of an aperture seat, the Pommel reduces the risk of clients sliding off the seat.

201-00139 Pommel (small aperture)
201-00140 Pommel (medium aperture)

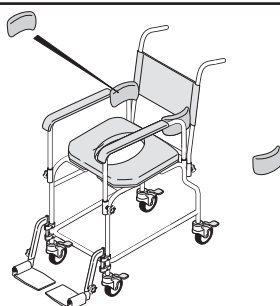

Thoracic support

Provides lateral support to the users trunk (adjustable)

CHCS3040 Thoracic support (pair)
CHCS3041 Thoracic support (LH*)
CHCS3042 Thoracic support (RH*)
*as sat in chair

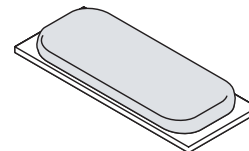

Padded foot tray

Soft padded support to suit sensitive feet. Clips over standard footplates.

201-00136 Foot tray 450mm (18")
CHCS3021 Foot tray 475mm (19")
203-00049 Foot tray 525mm (21")

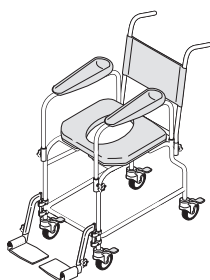

Channel armrest

Fitted instead of standard armrests to provide greater support to the users forearm

CHCS3060 Channel armrest (single)

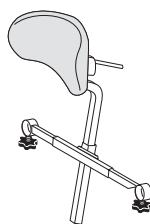

Head support

Provides padded support for the users head (fully adjustable to suit)

CHCS3050 Head support (push handle)
CHCS3051 Head support (straight handle)

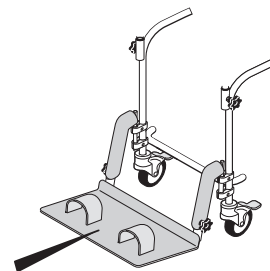

Foot tray

Black foot support tray with adjustable footstraps (footstrap size options available) c/w closed cell foam footrest supports.

CHCS049 17" Foot tray
CHCS049-1 19" Foot tray
CHCS049-2 21" Foot tray

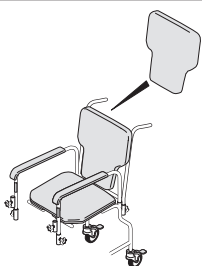

Back pad

Provides additional padded back support (17" wide only)
25/50/75mm thick options

CHCS3072 Back pad 17" 25mm (1")
CHCS3071 Back pad 17" 50mm (2")
CHCS3070 Back pad 17" 75mm (3")

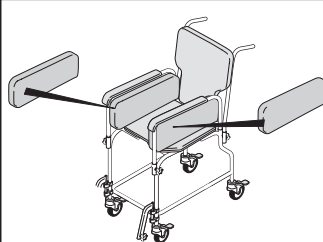

Side pad

Provides extra padded side support
25/50/75mm thick options

CHCS3082 Side pads 25mm (1")
CHCS3081 Side pads 50mm (2")
CHCS3080 Side pads 75mm (3")

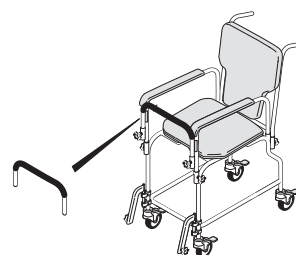

Front safety bar

Fitted across the front of the chair to provide extra support to the user and to prevent the risk of accidental fall includes adapted armrests

CHCS009 Front safety bar

For spare parts please contact customer services on 01869 365500 opt 1.

SYMBOLS: Bulk item

Made to order

Anti-microbial coating

(see P68 for details)



Tel: 01869 365500 Email: sales@chilterninvadex.co.uk

www.chilterninvadex.co.uk

SHOWER CHAIRS - AQUAMASTER TILT IN SPACE



AquaMaster Tilt in Space Shower & Toileting Chair



Maximum Load 160kg (25 stones) (350lb)

- Designed and tested in conjunction with Occupational Therapists and healthcare professionals
- Offers a safe, controlled and comfortable showering position for those with severe physical conditions
- Full range of aperture, horseshoe and flat padded seats available
- Option for bespoke seating, including pressure relief foam
- Armrest, backrest and footrest options
- Twin gas rams to ensure smooth reliable operation
- Single hand control lever for ease of use
- Stainless steel, powder coated construction for strength and durability
- Corrosion resistant stainless steel and nylon bracked castors. Directional locking castor available.
- Commode cradle options for round or oval pan types
- Paediatric model available see page 59 for details

code	product	description
A14	AquaMaster Tilt in Space 18" frame	Horseshoe, Aperture, Flat Padded Seat 18" (450mm)
A15	AquaMaster Tilt in Space 21" frame	Horseshoe, Aperture, Flat Padded Seat 21" (520mm)
A16	18" frame 90 degree backrest	Horseshoe, Aperture, Flat Padded Seat 18" (450mm)
A17	21" frame 90 degree backrest	Horseshoe, Aperture, Flat Padded Seat 21" (520mm)
A16C	18" frame Closomat Compatible	Horseshoe, Aperture, Flat Padded Seat 18" (450mm)
A17C	21" frame Closomat Compatible	Horseshoe, Aperture, Flat Padded Seat 21" (520mm)

Tilt in Space Shower chair custom made features

selection	description
Chair width	Available in custom widths (please specify width)
Height	Raise or lower seat height (state height, max + 150mm/6")
Backrest options	Additional recline (state angle of recline max 10 degrees)
	Additional recline (over 10 degrees)
	Height change (state height required)
	Full height backrest material
	Full height backrest fabric (mesh)
	Backrest cushion (state thickness - 25, 50 or 75mm/ 1", 2" or 3")
Seat options	Non standard seat
	Seat skirt (for padded horseshoe and padded aperture seats only)
	Extra padding (state thickness max +25mm/+ 1")
	Reduced or no padding (state thickness)
	Dartex seat covering
	Side access seat extended by 50mm or 75mm
	Change aperture dimension
	Pressure relief foam
Armrest options	Height increased or lowered (state height from top of seat)
	Length change
	Pair special soft pads
	Pair padded armrests (state thickness - 25, 50 or 75mm/ 1", 2" or 3")
	Pair gutter channel armrests
	Front safety bar (includes special armrests)
	Cranked armrests
	Bolted in armrests
Footrest options	Change footrest angle
	Double length footplate (pair)
	Velcro padding (per footrest)
	Raise footrest height
	Stump support (fixed, each)
	Heel straps
	Toe straps
	Heel and toe straps
Specialist	Thoracic supports (Ottobock) pair
	Adjustable, removable headrest (Ottobock)
	Chest and shoulder support harness (Ottobock)



SHOWER CHAIRS - AQUAMASTER TILT IN SPACE

Technical information

A14 & A15

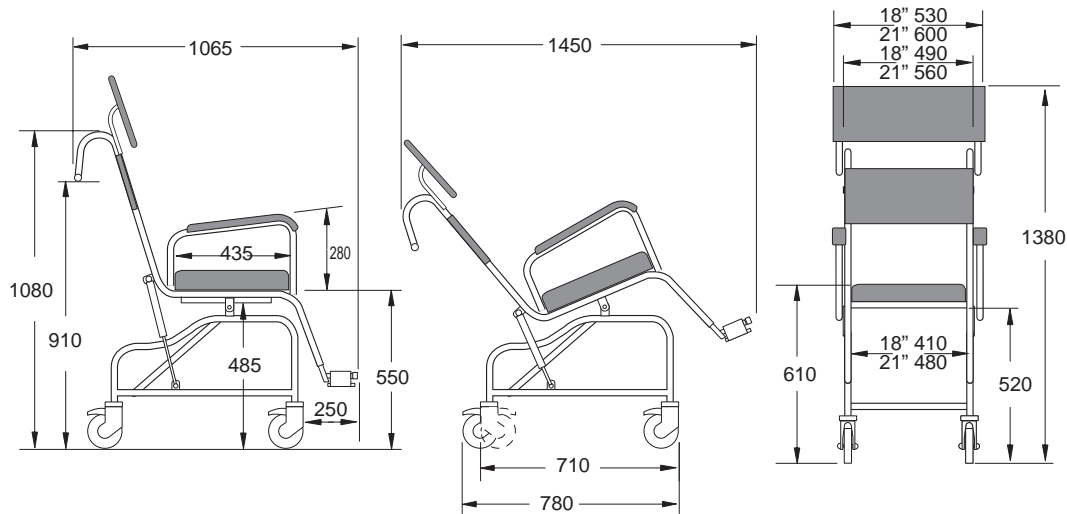

A16 & A17

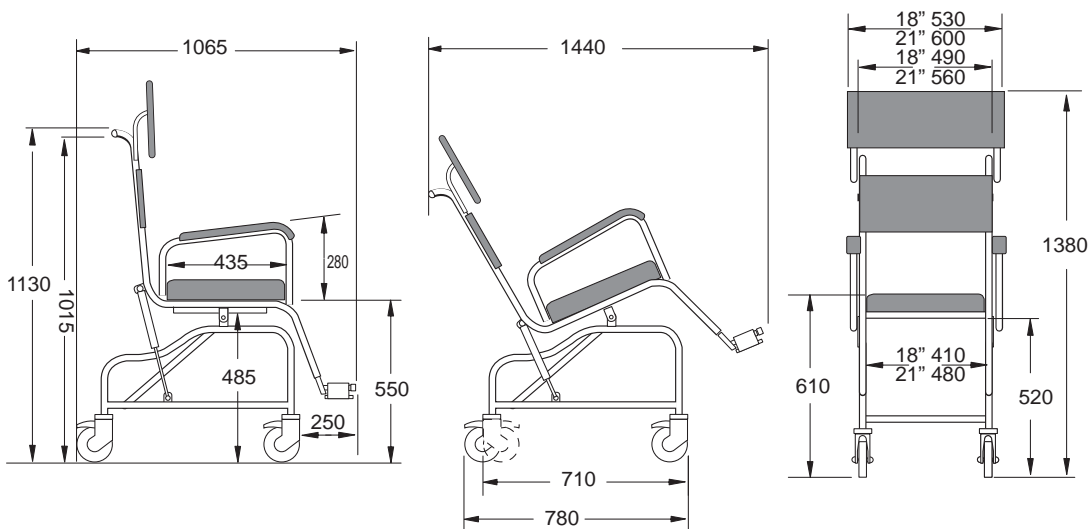

A16C & A17C

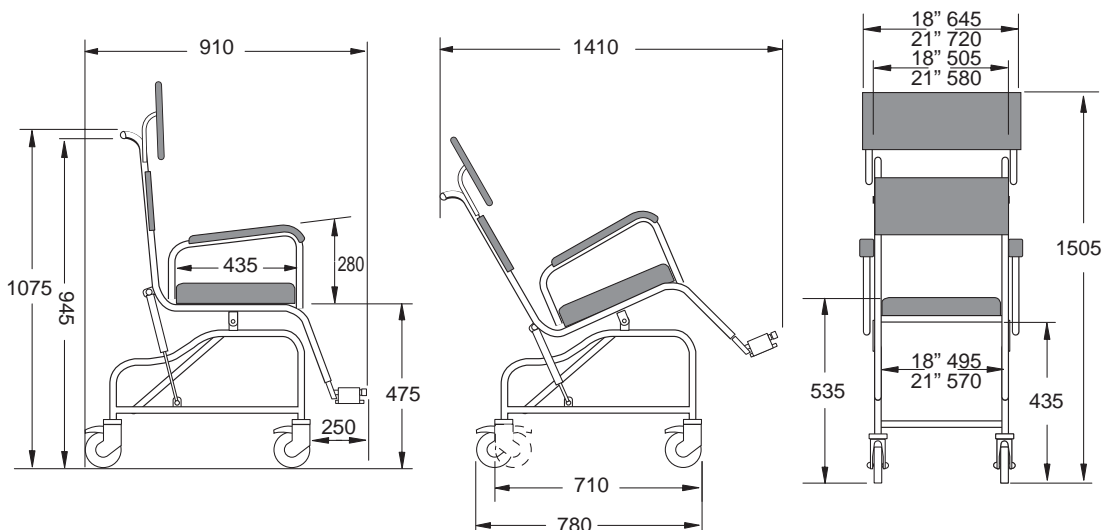

SYMBOLS: Bulk item

Made to order

Anti-microbial coating

(see P68 for details)



Tel: 01869 365500 Email: sales@chilterninvadex.co.uk

www.chilterninvadex.co.uk

SHOWER CRADLES - TILT IN SPACE



Shown with optional aperture and quilted side rails

Tilting Shower Cradle

Maximum Load 130kg (20 stones) (286lb)

- Designed and tested in conjunction with Occupational Therapists and healthcare professionals
- Offers a safe, controlled and comfortable showering position
- Twin gas rams to ensure smooth reliable operation
- Single hand control lever for ease of use
- Stainless steel, plastic dip coated construction for strength and durability
- Corrosion resistant stainless steel and nylon braked castors. Directional locking castor available.
- Available with or without aperture
- Easy drain mesh material which is removeable for cleaning
- Bespoke options available, subject to survey
- Range of accessories including head rests, lap straps and thoracic supports available

code	product
WASHCRADTISS	Tilting cradle (small)
WASHCRADTISM	Tilting cradle (medium)
WASHCRADTISL	Tilting cradle (large)

Paediatric model available see page 61

Tilt in Space Cradle custom made features

selection	description
Frame	Width change
	Raise or lower seat height
	Increase or reduce cradle length
Fabric options	Add aperture (small, medium or large)
	Add non-standard aperture
	Add lap strap/chest strap
Side rails	Addition of side rails
	Enveloped rails
	Padded rails
	Quilted rails
Specialist	Thoracic support rolls
	Adjustable, removable headrest support
	Dartex head cushion
	Dartex knee support
	Footboard
	Dartex pommel

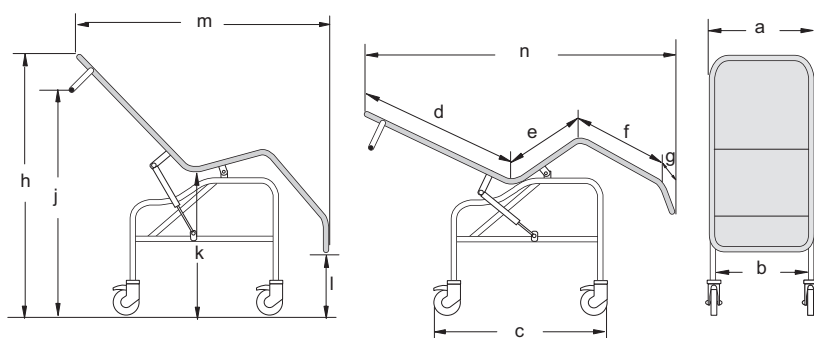

Reclined cradle with optional padded side rails

	a	b	c	d	e	f	g	h	j	k	l	m	n
Small	500	510	780	620	280	400	150	1170	1020	660	300	820	1210
Medium	500	510	780	750	350	480	150	1260	1110	650	200	1120	1430
Large	575	575	780	900	400	570	150	1350	1200	640	150	1440	1740



SHOWER CRADLES



Washington Shower Cradle

Maximum Load 130kg (20 stones) (286lb)

- Safe, comfortable bathing for those with degenerative or severe physical conditions
- Small, medium and large size options
- Removable and washable cover to maintain hygiene levels
- Adjustable to three positions to suit individual requirements
- Adjustable fabric to create a hammock effect for added safety

code	product
WASHCRADS	Washington Shower Cradle (Small)
WASHCRADM	Washington Shower Cradle (Medium)
WASHCRADL	Washington Shower Cradle (Large)

Shower cradles custom made features

code	product
WASHCRADSPEC	Frame change raised in height
	Length or width change
	Side bars per/pair
	Envelope fabric
	Padding for envelope
	Additional lugs per pair
	Aperture in fabric
	Velcro type chest strap (same as toileting sling)
	Waist strap sewn to fabric
	Fabric length change
	Head cushion

Technical Information

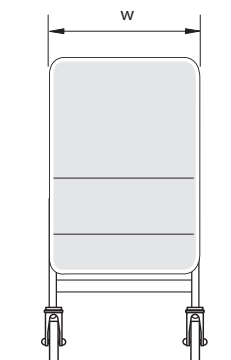
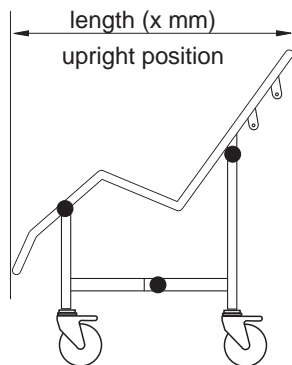
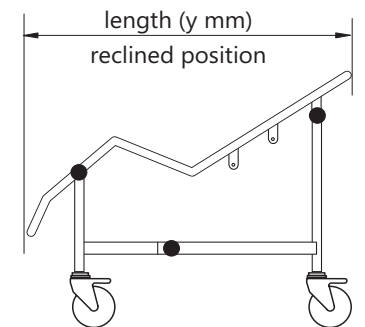
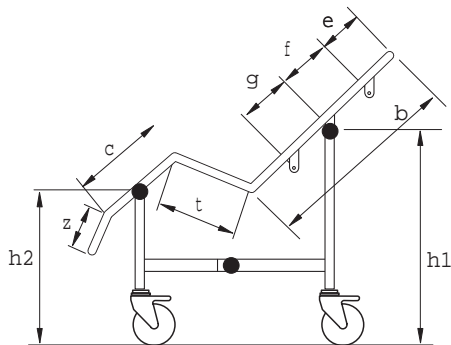

	b	c	e	f	g	h1	h2	t	w	x	y	z
S	620	400	140	120	120	815	620	280	500	970	1120	150
M	750	480	150	150	150	815	670	350	500	1270	1380	150
L	900	570	180	170	170	815	670	400	575	1590	1690	150

SYMBOLS: Bulk item
Made to order
Anti-microbial coating
(see P68 for details)



Tel: 01869 365500 Email: sales@chilterninvadex.co.uk
www.chilterninvadex.co.uk

SHOWER TROLLEYS & STRETCHERS



Shower Trolley (hydraulic/electric)

Maximum Load 190kg (30 stones) (418lb)



- Clients can be showered and dried without manual handling
- Braked castors prevent movement during transfer
- Convenient drop sides
- Fixed height, electric operation or hydraulic height adjustment to avoid stretching or leaning
- Padded liner with head support for comfort
- Liners are now available in a selection of colours please contact customer services for details

code	product
TRT1	Shower Trolley Hydraulic (1930mm x 720mm)
TRT2	Shower Trolley Fixed Height (1930mm x 720mm) fixed at 800mm high
TRT3	Shower Trolley Hydraulic (1600mm x 720mm)
TRT4	Shower Trolley Electric (1930mm x 720mm)

Note: If a size not detailed is required please contact Chiltern Invadex to arrange a visit from a Technical Sales Representative.

Technical Information

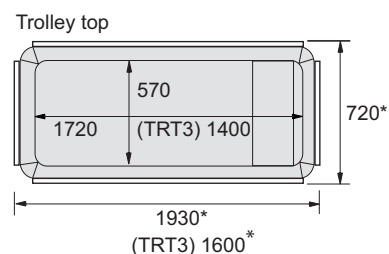
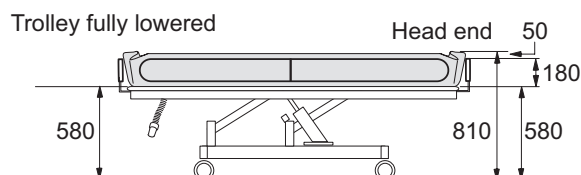
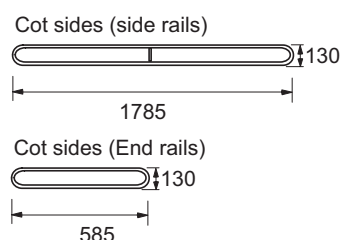
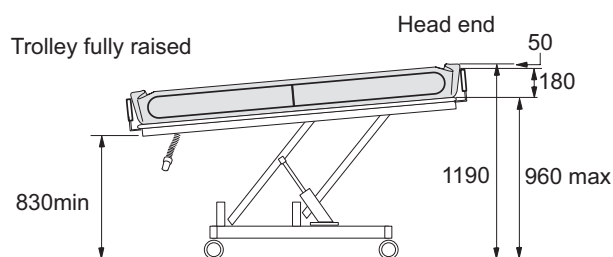

Dimension indicated * shows overall dimensions from outside of cot sides

Shower trolleys custom made features

code	product
TRT1SPEC	Length change (1400/1500/1600/1700/1800mm options)
	Width change (600/650/750/800mm options)
	Coloured liner - various colour options available

Extended delivery times apply.



SYMBOLS: Bulk item
Made to order
Anti-microbial coating
(see P68 for details)



Tel: 01869 365500 Email: sales@chilterninvadex.co.uk
www.chilterninvadex.co.uk

SHOWER TROLLEYS & STRETCHERS



Folding Stretcher

Maximum Load 130kg (20 stones) (286lb)



- Clients can be showered and dried without manual handling
- Braked castors prevent movement during transfer
- Height adjustment to three levels to avoid stretching
- Folds for storage
- Optional side rails and head support

code	product
TRT17	Folding shower stretcher
TRTS040	Side rail (each)
CH0530	Head cushion (flat)
TRTS003	Head cushion (wedge shaped)

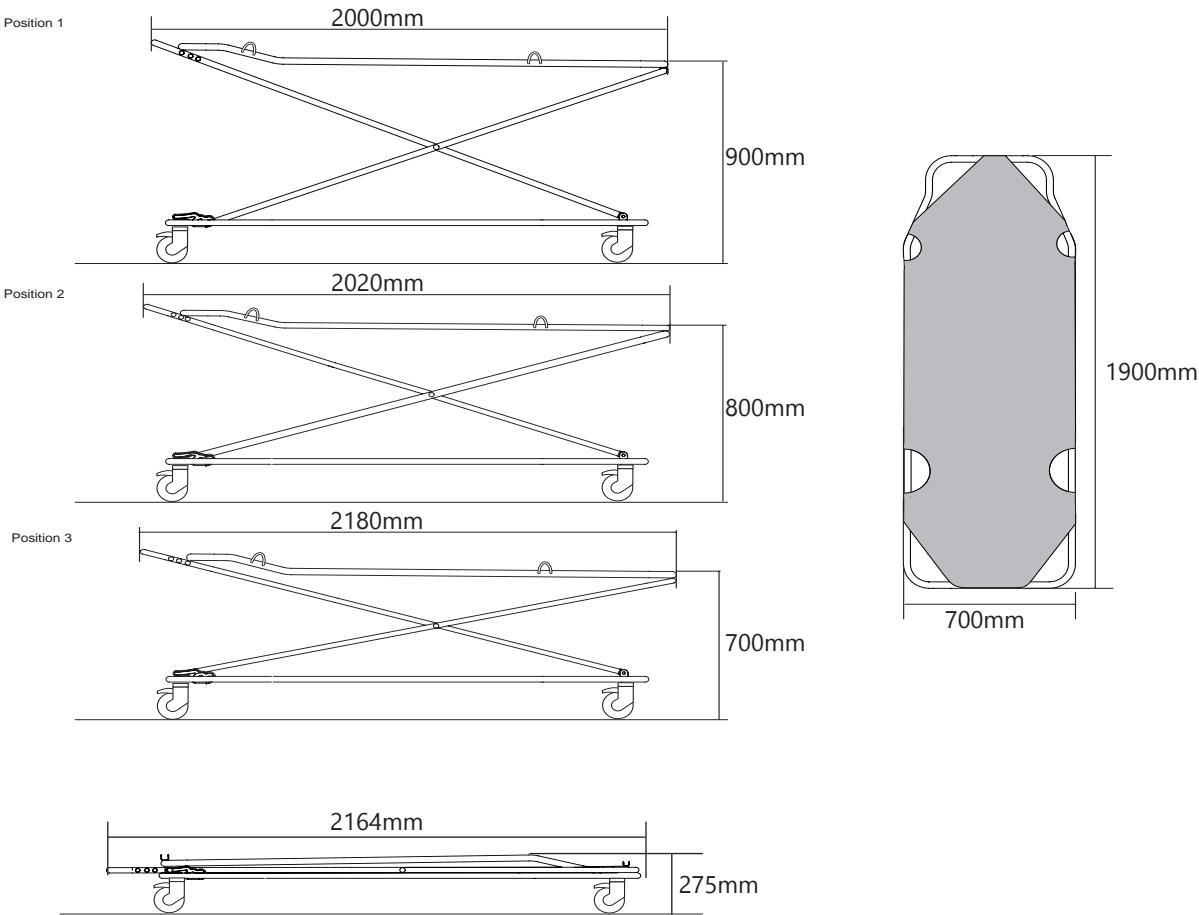

SHOWER TROLLEYS & STRETCHERS



Shower/changing stretcher

Maximum Load 130kg (20 stones) (286lb)

- Allows clients to be washed over a bath or in a shower area
- Folds flat against the wall for neat storage
- Drain holes for quick water drainage



code

TRT11

product

Wall Mounted Tip up Shower/Changing Stretcher (1900mm x 700mm)

Note: T11 has no backrest and is not handed. If a size not detailed is required please contact Chiltern Invadex to arrange a visit from a Technical Sales Representative.

Technical Information TRT11

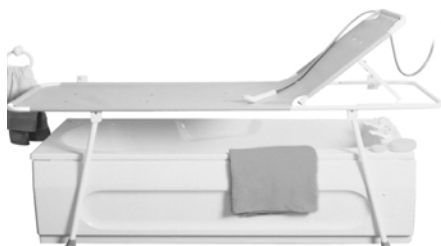
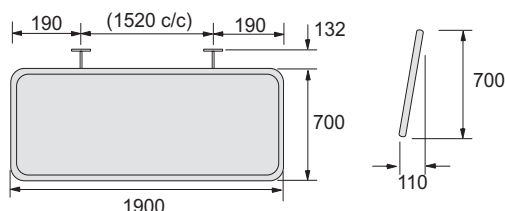
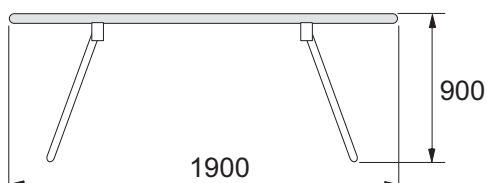

Shower/changing stretcher with adjustable back

Maximum Load 130kg (20 stones) (286lb)

- Allows clients to be washed over a bath or in a shower area
- Folds flat against the wall for neat storage
- Drain holes for quick water drainage
- Adjustable back can be locked in various positions to suit the user



code

TRT12

product

Wall Mounted Tip up Shower/Changing Stretcher with Adjustable Backrest (1900mm x 700mm)

Note: Standard T12 has the adjustable backrest on the right hand side as pictured. If the opposite hand is required please contact the Technical Helpdesk for assistance. If a size not detailed is required please contact Chiltern Invadex to arrange a visit from a Technical Sales Representative.

Technical Information T12

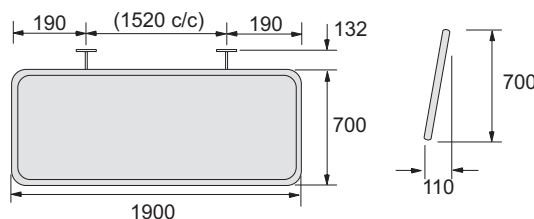
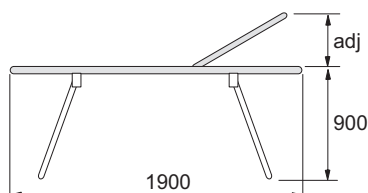

TRT11 & TRT12 Shower stretchers custom made features



product

Height change (800/850/950/1000mm options)

Length change (1400/1500/1600/1700/1800mm options)

Width change (600/650/750/800mm options)

Distance off wall change (75/100/150mm options)

Fitted with cot sides

Skirt on front edge of stretcher (350mm deep)

Extended delivery times apply

SYMBOLS: Bulk item

Made to order

Anti-microbial coating

(see P68 for details)



Tel: 01869 365500 Email: sales@chilterninvadex.co.uk

www.chilterninvadex.co.uk

SHOWER TROLLEYS & STRETCHERS



Shower/Changing Stretcher Padded Liner

Maximum Load 190kg (30 stones) (418lb)

- Padded liner complete with sides, head support cushion & drop sides
- Safe, comfortable bathing
- Sturdy design provides reassurance for the bather
- Liners are now available in a selection of colours please contact customer services for details

code	product
TRT13	Wall Mounted Tip up Shower/Changing Stretcher (1930mm x 715mm)

Note: If a size not detailed is required please contact Chiltern Invadex to arrange a visit from a Technical Sales Representative.

Technical Information TRT13

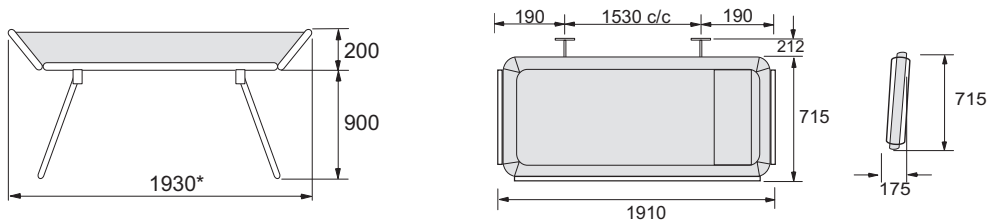



Dimension indicated * shows overall dimensions from outside of cot sides

Shower stretchers custom made features

code	product
TRT13SPEC	Height change (800/850/950/1000mm options)
	Length change (1400/1500/1600/1700/1800mm options)
	Width change (600/650/750/800mm options)
	Distance off wall change (150mm/200mm options)
	Coloured liner - various colour options available

SYMBOLS: Bulk item
 Made to order
 Anti-microbial coating
 (see P68 for details)

HEIGHT ADJUSTABLE SHOWER STRETCHERS



Height adjustable shower/changing stretcher Maximum Load 150kg (23 stones) (330lb)

- Height adjustable via handset to suit carer requirement and transfer
- Height adjustment between 500mm and 900mm above floor level
- 1400 and 1800 length options
- Reliable electric motor
- Comfortable PVC coated canvas with drainage holes
- Folds against wall when not in use
- Optional skirt to protect carer from splashes
- Sturdy design provides reassurance for the bather

code	product
IDPRS03	Wall Mounted height adjustable stretcher (1800mm x 600mm) with cot side
IDPRS04	Wall Mounted height adjustable stretcher (1400mm x 600mm) with cot side
IDPRSK1	Skirt to suit 1800mm stretcher
IDPRSK2	Skirt to suit 1400mm stretcher



Optional skirt

Technical Information

1400mm model

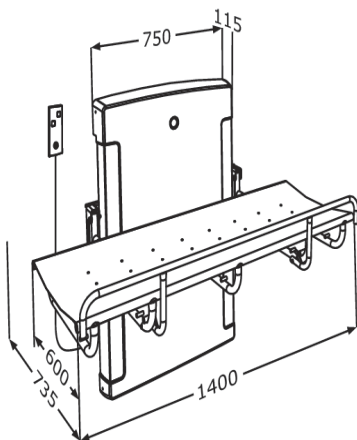

1900mm model

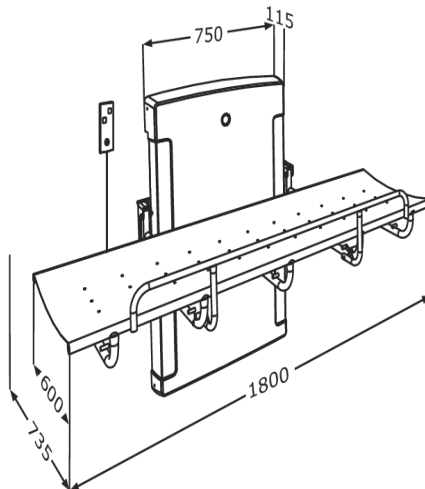

HEIGHT ADJUSTABLE SHOWER STRETCHERS



Height adjustable shower/changing stretcher Maximum Load 200kg (31 stones) (440lb)

- Height adjustable via handset to suit carer requirement and transfer
- Height adjustment between 300mm and 1000mm above floor level
- 1300 and 1800 length options
- Reliable electric motor
- Adjustable head support
- Folds against wall when not in use
- Integral water collection tray
- 1500mm flexible hose
- Curved base provides safe, comfortable bathing
- Sturdy design provides reassurance for the bather

Shown with optional cot side

code	product
IDPRS07	Wall Mounted height adjustable stretcher (1800mm x 700mm) with cot side
IDPRS08	Wall Mounted height adjustable stretcher (1300mm x 700mm) with cot side



Technical Information

1800mm model

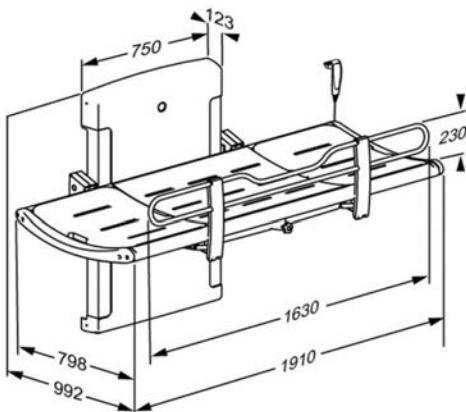

1300mm model

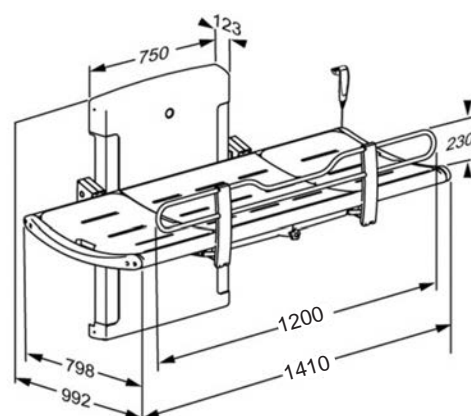

SYMBOLS: Bulk item
Made to order
Anti-microbial coating
(see P68 for details)



Tel: 01869 365500 Email: sales@chilterninvadex.co.uk
www.chilterninvadex.co.uk



PAEDIATRIC RANGE



PAEDIATRIC RANGE – SLINGS











Paediatric Sling Range

The Chiltern Invadex sling range offers a number of paediatric sizes in various fabrics and colours to make the hoisting experience less clinical. Each model and fabric range has been extensively tested to ensure the comfort and safety of the user.

For full details of sizing and order codes please see pages 24-32

We now offer the following paediatric ranges;

-  Universal - a general use sling offering good lower body support.
-  Universal Deluxe - a full support sling providing boned, padded head support.
-  Deluxe Hammock - offers secure, comfortable fit around the hips, with toileting aperture.
-  Extensor Hammock - Deluxe hammock with extensor straps and padded head support.
-  In-Situ Hammock - an in-chair spacer sling provided with strap pockets.
-  Classic Toileting - a classic toileting sling with wide padded legs for comfort.
-  Deluxe Toileting - classic toileting sling with extensor straps and head support.
-  Full Support Toileting - toileting sling with self tightening body straps, allowing users arms to remain inside the sling during transfer.

In addition to standard blue polyester, paediatric slings are offered in mesh and 3D spacer fabrics, colour options are also available.

Cartoon fabrics* can be used to line the slings providing visual stimulation and a sense of personalisation.

Where a child has specific needs, we are able to produce custom made slings to ensure that they feel secure and comfortable during transfer. For a full product brochure or to request a survey/demonstration visit please contact customer services on 01869 365500 Opt 1 or email us at sales@chilterninvadex.co.uk.

*cartoon fabrics vary, please contact customer services for details of current stock.

Chiltern slings have been developed to complement the Wispa range of hoists, however can be used with various two and three prong spreader bars (subject to assessment of risk).

The Wispa 100+ can now be customised using a sticker pack which can be provided to enable the child to print their own image and apply to the hoist sides.



PAEDIATRIC RANGE – SHOWER CHAIR



AquaMaster Paediatric Shower Chair



The paediatric shower chair has all of the features of the popular AquaMaster range, perfectly proportioned to suit paediatric use. A large range of side pads, thoracic supports and support straps allow the chair to be adapted to suit smaller children. The paediatric chair is available with numerous frame colours.*

The AquaMaster range of shower commode chairs provides a rigid one piece base frame with modular elements to allow easy replacement of components to suit the users changing needs. Seats, armrests and footrests which are interchangeable. The chair also features a wide range of accessories and is available as a made to measure piece of equipment, specially manufactured at our Oxfordshire facility to meet individual needs. The coated frame features an anti-microbial element which is proven to destroy 99.9% of harmful bugs including MRSA.

Main Features

- Safe working load 130kg (20st) (286lb)
- The chair features a rigid one piece base frame.
- Removeable armrests and footrests swing away to aid transfer.
- Several footrest options are available, each is height adjustable to ensure that the user is in a comfortable position.

- Seats are available as flat padded, full ring aperture or horseshoe with a range of aperture sizes to suit the user.
- Options extended seats and pressure relief foam.
- Optional commode pan and cradle or sliders available
- Option for 20" or 22" self propelling wheels
- Attendant propelled models are provided with four braked castors, directional locking castor available on request.
- Each model can be manufactured as a bespoke, user specific model (subject to site survey)

*please call us for a colour chart.

code	product	description
A20	Paediatric Chair Attendant Propelled	Horseshoe, Aperture, Flat Padded seat
A21	Paediatric Chair Self Propelled	Horseshoe, Aperture, Flat Padded Seat

A20 Attendant propelled model

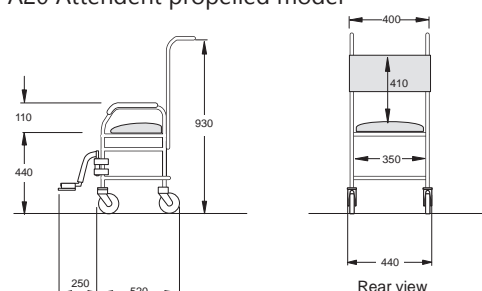

A21 Self propelled model

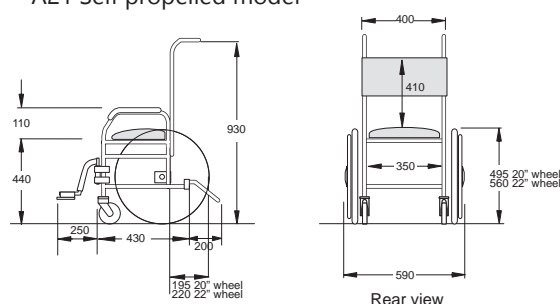

Special Features

selection	description
Chair width	Available in custom widths
Height	Raise or lower seat height (maximum increase +150mm/6")
Backrest options	Additional recline (upto10 degrees)
	Additional recline (over 10 degrees)
	Height change
	Full height backrest material
	Full height backrest fabric (mesh)
	Backrest cushion (state thickness - 25, 50 or 75mm/ 1", 2" or 3")
Seat options	Non standard seat
	Seat skirt (for padded horseshoe and padded aperture seats only)
	Extra padding (maximum +25mm/+ 1")
	Dartex seat covering
	Change aperture dimension
	Pressure relief foam
Armrest options	Height increased or lowered
	Length change
	Pair special soft pads
	Cranked armrests
Footrest options	Change footrest angle
	Velcro padding (per footrest)
	Raise footrest height

The above list shows the most commonly requested special features, additional items are available please call customer services to discuss specific requirements on 01869 365500 opt 1. See following page for accessories.

SYMBOLS: Bulk item
Made to order
Anti-microbial coating
(see P68 for details)



Tel: 01869 365500 Email: sales@chilterninvadex.co.uk
www.chilterninvadex.co.uk

PAEDIATRIC RANGE – SHOWER CHAIR



Commode pan round

201-00147 Round pan

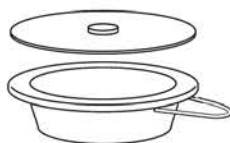

Commode pan oval

201-00144 Oval pan

Footrests with toe straps

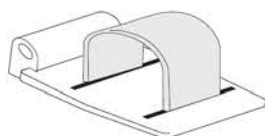

Used instead of standard footplates. Prevents involuntary movements and protects the user/carer against injury.

211-00528-1 Left hand*
211-00529-1 Right hand*

Footrests with heel straps

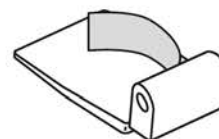

Provides additional support for feet. Prevents the user from slipping off the back and falling forwards.

211-00521 Left hand*
211-00520 Right hand*

Footrests with heel straps/toe straps

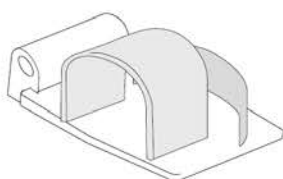

Provides total support of feet against involuntary movement

211-00525 Left hand*
211-00524 Right hand*

Padded foot tray

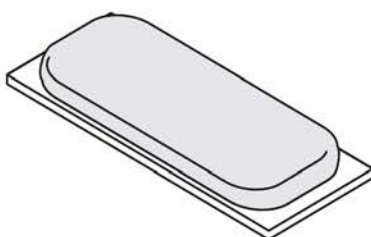

Soft padded support to suit sensitive feet. Clips over standard footplates.

201-00154 Paediatric

Individual foot pad



Soft padded support to suit sensitive feet. Clips over standard footplates.

CHCS057 Not handed

Postural support



Supports the waist and prevents involuntary movement of upper body/accidentally slipping out of chair.

201-00150 Extra Small
201-00151 Small

Sternum harness



Prevents involuntary movement of upper body/accidentally slipping out of chair.

201-00154 Extra Small
201-00155 Small

Calf strap

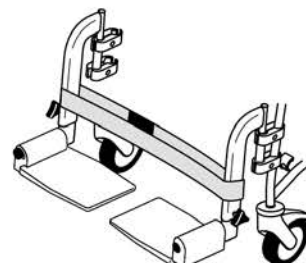

Attaches around both footrest holders. Provides support to the lower leg.

201-00146 Paediatric

SYMBOLS: Bulk item

Made to order

Anti-microbial coating

(see P68 for details)



Tel: 01869 365500 Email: sales@chilterninvadex.co.uk

www.chilterninvadex.co.uk

PAEDIATRIC RANGE – TILTING SHOWER CHAIR (TO SPECIAL ORDER)



AquaMaster Tilt in Space Shower & Toileting Chair



Maximum Load 160kg (25 stones) (350lb)

- Designed and tested in conjunction with Occupational Therapists and healthcare professionals
- Offers a safe, controlled and comfortable showering position for those with severe physical conditions
- Full range of aperture, horseshoe and flat padded seats available
- Option for bespoke seating, including pressure relief foam
- Armrest, backrest and footrest options
- Twin gas rams to ensure smooth reliable operation
- Single hand control lever for ease of use
- Stainless steel, powder coated construction for strength and durability
- Corrosion resistant stainless steel and nylon braced castors. Directional locking castor available.
- Commode cradle options for round or oval pan types

code	product	description
A18	AquaMaster Tilt in Space 15" frame	Horseshoe, Aperture, Flat Padded Seat 15"

Paediatric Tilt in Space Shower Chair Options

selection	description
Chair width	Available in custom widths (please specify width)
Height	Raise or lower seat height (state height, max + 150mm/6")
Backrest options	Additional recline (state angle of recline max 10 degrees)
	Additional recline (over 10 degrees)
	Height change (state height required)
	Full height backrest material
	Full height backrest fabric (mesh)
	Backrest cushion (state thickness - 25, 50 or 75mm/ 1", 2" or 3")
Seat options	Non standard seat
	Seat skirt (for padded horseshoe and padded aperture seats only)
	Extra padding (state thickness max +25mm/+ 1")
	Reduced or no padding (state thickness)
	Dartex seat covering
	Side access seat extended by 50mm or 75mm
	Change aperture dimension
	Pressure relief foam
Armrest options	Height increased or lowered (state height from top of seat)
	Length change
	Pair special soft pads
	Pair padded armrests (state thickness - 25, 50 or 75mm/ 1", 2" or 3")
	Pair gutter channel armrests
	Front safety bar (includes special armrests)
	Cranked armrests
	Bolted in armrests
Footrest options	Change footrest angle
	Double length footplate (pair)
	Velcro padding (per footrest)
	Raise footrest height
	Stump support (fixed, each)
	Heel straps
	Toe straps
	Heel and toe straps
Specialist	Thoracic supports (Ottobock) pair
	Adjustable, removable headrest (Ottobock)
	Chest and shoulder support harness (Ottobock)

To special order only, a visit from one of our surveyors is highly recommended. Please contact customer services to arrange a joint visit on 01869 365500 opt 1.

For technical info see page 60

SYMBOLS: Bulk item
Made to order
Anti-microbial coating
(see P68 for details)



Tel: 01869 365500 Email: sales@chilterninvadex.co.uk
www.chilterninvadex.co.uk

PAEDIATRIC RANGE – TILTING SHOWER CHAIR (TO SPECIAL ORDER)

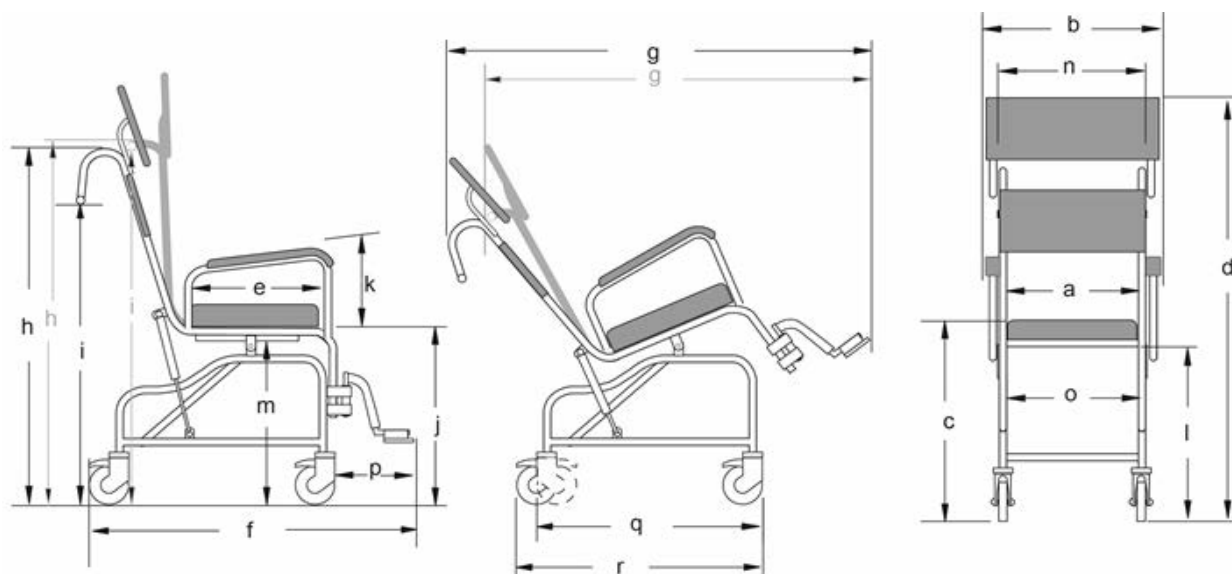

a	Seat width	325
b	Overall width	470
c	Seat height	600
d	Overall height (fabric headrest at full extension)	1095
e	Seat depth	360
f	Overall depth	980
g	Overall tilted depth (headrest at full extension)	1210
g	Overall tilted depth (headrest at full extension)	1150
h	Height to top of push handle backrest	1110
h	Height to top of push handle backrest	1150
i	Height to underside of push handle backrest	940
i	Height to underside of push handle backrest	1140
j	Height from floor to top of seat at front	550
k	Height of armrest pad from frame at front	220
l	Height from floor to underside of frame at rear	525
m	Height from floor to underside of commode rack	415
n	Width of backrest	425
o	Internal clearance width of frame	400
p	Projection of footplates from front edge of castor	200
q	Length of chair castors toed in	720
r	Length of chair castors in line	780



PAEDIATRIC RANGE – TILT IN SPACE CRADLE



Shown with optional aperture and quilted side rails

Paediatric Tilting Shower Cradle

Maximum Load 130kg (20 stones) (286lb)



- Designed and tested in conjunction with Occupational Therapists and healthcare professionals
- Offers a safe, controlled and comfortable showering position
- Twin gas rams to ensure smooth reliable operation
- Single hand control lever for ease of use
- Stainless steel, plastic dip coated construction for strength and durability
- Corrosion resistant stainless steel and nylon braked castors. Directional locking castor available.
- Available with or without aperture
- Easy drain mesh material which is removeable for cleaning
- Bespoke options available, subject to survey
- Range of accessories including head rests, lap straps and thoracic supports available
- Frame colour options available

code

WASHCRADTISP

product

Tilting cradle (paediatric)

Tilt in Space Cradle custom made features

selection	description
Frame	Width change
	Raise or lower seat height
	Increase or reduce cradle length
Fabric options	Add aperture (small, medium or large)
	Add non-standard aperture
	Add lap strap/chest strap
Side rails	Addition of side rails
	Enveloped rails
	Padded rails
	Quilted rails
Specialist	Thoracic support rolls
	Adjustable, removable headrest support
	Dartex head cushion
	Dartex knee support
	Footboard
	Dartex pommel



Shown in fully reclined position with optional head cushion

Frame colour options available, please call for details



Shown in upright position

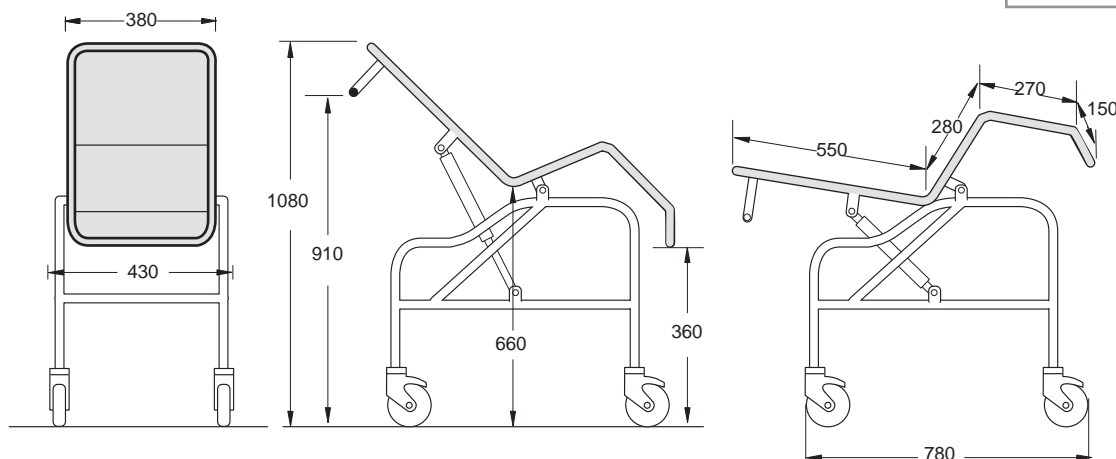

SYMBOLS: Bulk item

Made to order

Anti-microbial coating
(see P68 for details)



Tel: 01869 365500 Email: sales@chilterninvadex.co.uk







www.chilterninvadex.co.uk

PAEDIATRIC RANGE – SHOWER TROLLEY



Paediatric Shower Trolley

Maximum Load 190kg (30 stones) (418lb)

-  Clients can be showered and dried without manual handling
-  Braked castors prevent movement during transfer
-  Convenient drop sides
-  Hydraulic height adjustment to avoid stretching or leaning, available as static height or with electric actuator as special order
-  Padded liner with head support for comfort
-  NEW liners are now available in a selection of colours please contact customer services for details

code	product
TRT3	Shower Trolley Hydraulic (1600mm x 720mm)

For adult models 1900mm long see page 54

Technical Information

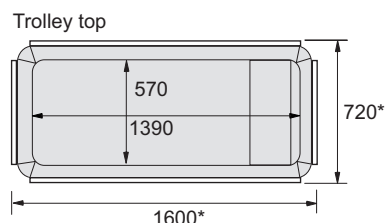
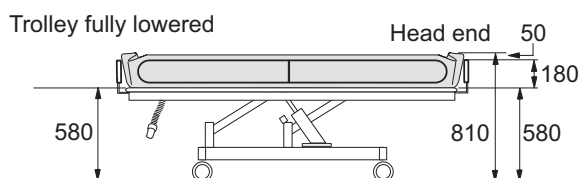
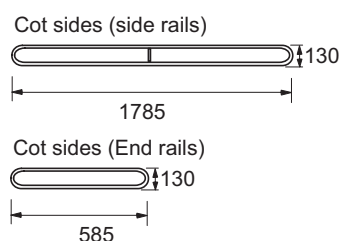
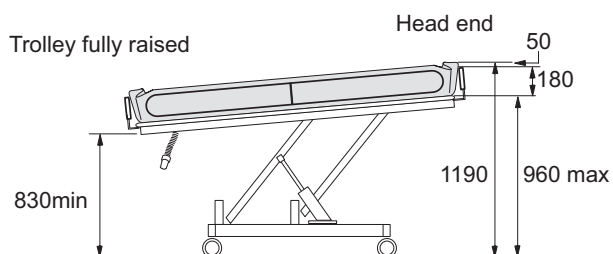

Dimension indicated * shows overall dimensions from outside of cot sides

Shower trolleys custom made features

code	product
TRT3SPEC	Length change
	Width change
	Coloured liner - 20 colour options available
	Static model
	Electric model



SYMBOLS: Bulk item
Made to order
Anti-microbial coating
(see P68 for details)





Tel: 01869 365500 Email: sales@chilterninvadex.co.uk
www.chilterninvadex.co.uk

GENERAL INFORMATION

Delivery policy

Chiltern Invadex products are normally available from stock with the following exceptions:

1. Products which are Made to Order are shown with a  symbol. Lead times can range from 7 days for standard product to 6-8 weeks for bespoke products, dependent upon the scope of the specification changes. Please call customer services on 01869 365500 Opt 1, for details of specific products
2. Oversized or bulk items are shown with a  symbol and may attract additional carriage charges. Delivery times may differ from our standard terms, please refer to customer services for details.
3. Additional delivery options such as timed deliveries are available at an additional charge. This requirement must be advised at time of order and may not be available for oversized items or for the Scottish Highlands and Islands. Please call for details.

Anti-microbial Coating

Items which are identified by a  symbol are rust free stainless steel coated with Talisman 30ES AM performance polymer alloy which includes a silver anti-microbial additive to reduce levels of MRSA by at least 99.9%

Surveyor visits

Chiltern Invadex has a Nationwide team of experienced representatives who are able to make site visits to assist in the specification of equipment and provide quotations.

Surveyor visits are available at no charge and are non-obligation. To arrange a visit please contact customer services on 01869 365500 Opt 1.

Specification changes

As part of our commitment to new product development we reserve the right to alter specifications without prior notice.

